



INTEX[®]
MILLWORK SOLUTIONS



Product Catalog

2021

intexmillwork.com



INTEX Millwork Solutions Product Catalog 2021

Understanding New Icons & Page Types

SECTION INTRO PAGES:

A high-level break down of the standard offerings for our core products – most affordable, mid-grade and premium, followed by a custom option.

HOW TO ORDER PAGES:

A handy checklist with easy-to-follow steps to help guide you through the ordering process.



PRICE KEY: Shows lowest to highest price point.



INSTALL KEY: Shows range from DIY-friendly to craftsman level installation.



Welcome to INTEX Millwork

Proudly Hand-Crafted in America Since 2006!

We are a family company who values trusted relationships with its partners and offers top-notch customer service with exceptional lead times, no matter how basic or complex the project.

Builders, contractors, and architects enjoy the peace of mind that comes with a manufacturer they can trust for support from first inquiry through installation. INTEX will go above and beyond to ensure their partners are satisfied with their products and service.

Learn more at intexmillwork.com



FIND US ON YOUR FAVORITE CHANNELS
@intexmillwork | #intexmillwork

SECTION 01: RAILING SYSTEMS

page 4 ↗

How to Order Extruded Rail Kits.....	7
Liberty Rail.....	8
Hampton Rail.....	10
Providence Rail.....	12
Dartmouth Rail.....	14
Custom Nautilus Rail.....	16
Railing Upgrades & More	18

SECTION 02: NEWEL WRAPS

page 27 ↗

How to Order Newel Wraps.....	29
Extruded & Fabricated Newels.....	31
Lighted Newel Caps.....	32
Millwork Newel Wraps.....	33
Millwork Newel Caps.....	34
Custom Newel Wraps	35

SECTION 03: COLUMN WRAPS

page 36 ↗

How to Order Column Wraps.....	39
Knocked Down Easy Wraps	40
Assembled Easy Wraps	41
Millwork Column Wraps	42
Custom Column Wraps	43

SECTION 04: PERGOLA SYSTEMS

page 44 ↗

How to Order Pergolas.....	47
Classic Pergolas.....	48
Deluxe Pergolas	50
Premium Pergolas.....	52
Custom Pergolas.....	54
How to Order Trellis Systems.....	57

SECTION 05: FENCE SYSTEMS

page 58 ↗

How to Order Estate Fence	59
Estate Fence.....	60
Custom Fence.....	62

SECTION 06: MILLWORK & MORE

page 63 ↗

Shower Enclosures	64
Window Boxes & More.....	65
Shutters.....	66
Hollow Brackets & Rafter Tails	68
Mouldings, Trim, & More.....	70
Additional Applications.....	72
For the Architect.....	74



RS60 Liberty Extruded Rail

Easy installation similar to routed vinyl rail, with the fit and finish of traditional wood rail.

- 

Rated for 10ft residential & commercial level spans
Rated for 10ft residential stair spans
Rated for 8ft commercial stair spans







RS40 Hampton Extruded Rail
RS70 Providence Extruded Rail

Screw-together system that installs faster and easier than comparable composite rail, with the fit and finish of traditional wood rail.

- 

Rated for 10ft residential & commercial level spans
Rated for 8ft residential & commercial stair spans







RS35 Dartmouth Extruded Rail

Screw-together system with all the value of our Hampton Rail, at a larger scale — perfect for commercial and large-scale residential projects.

- 

Rated for 12ft residential & commercial level spans
Rated for 8ft residential & commercial stair spans







RS10-RS20-RS50 Nautilus Milled Rail

Custom milled railing, designed to your exact specifications. Renders custom wood rail obsolete.

- 

Rated for 10ft residential & commercial level spans
Rated for 8ft residential & commercial stair spans







Section 01
Railing Systems

Common Features

Extruded Rail Kits

Nothing adds distinction and definition to homes and outdoor living spaces like a stylish exterior railing. Both beautiful and functional, a deck or exterior railing can be stunningly elegant, classically simple or designed as a wrap-around porch with real curb appeal. Cellular PVC railings are a great choice for your railing system.

All Extruded INTEX Rails:

- Matte Finish - 100% Cellular PVC with Aluminum-Reinforced Core
- Hidden Stainless Steel Fasteners
- Solid Square-Edge Balusters and Square-Edge Posts
- 5" Standard Newel Cover with 6", 8" 10" and 12" Available as Upgrades
- Choice of Pyramid or Flat Newel Cap with Others Available as Upgrades
- Steel Post Mounts for Traditional and Over-the-Post Applications
- Independent Lab Tested And Certified With Code Compliance Research Report (CCRR)
- Do Not Require Paint, But Can Be Painted with a Light Reflective Value (LRV) of 55 or Greater



Common Upgrades for Extruded Kits



How to Order Extruded Rail Kits

Step 1

Select a Structural Post

☐ INTEX Structural Post Mount

☐ Wood Mount Hardware☐ Concrete Mount Hardware

☐ Pressure Treated 4x4☐ Pressure Treated 6x6

Step 2

Select a Newel Post Wrap Size & Style

☐ NEWEL5-EX

Fits 4 x 4 Or Structural Post Mount

☐ NEWEL5

Fits 4 x 4 Or Structural Post Mount

☐ NEWEL6.5

Fits 4 x 4, 6 x 6, Or Structural Post Mount

Step 3

Select a Style & Size for Newel Cap + Base Trim

Injection Molded Cap & Base

☐ IMPC5☐ IMTR5

Cellular PVC Caps & Bases

☐ NCFLAT☐ NCPYRAMID☐ NCHAR5☐ NBTR

For Upgraded Cap Styles See Page 34

Step 4

Select a Rail Profile

☐ RS60 Liberty Rail

RS60275RS60350Bottom Rail

☐ RS40 Hampton Rail

RS40350FRS40350PBottom Rail

☐ RS70 Providence Rail

RS70Bottom Rail

☐ RS35 Dartmouth Rail

RS35400RS35350Bottom Rail

Step 5

Select a Rail Height

☐ 36" Rail Height

☐ 42" Rail Height

Step 6

Select Desired Gate(s) and or Upgrades (If Any)

☐ Single Gates☐ Double Gates☐ Decorative Panels☐ Radius Rail☐ Glass Balusters☐ Glass Panels*☐ 3-Line Rail*☐ Mahogany Top Cap*☐ Lighted Newel Caps☐ Louver Infill*☐ Horizontal Balusters*

Rail Upgrades, *Including Availability By Rail Line, Start on Page 18

Liberty Extruded Rail

Unique Routed Rail System That Saves on Labor and Material Costs!



Unique Liberty Rail Features

- Pre-Routed For Easy Installation - Save On Labor!
- Our 2 3/4" Flat Top Profile Is Irc Code R311.7.8.3 Compliant For Residential Stair Graspability
- Standard Kits Ship With Solid 1 1/4" Square-Edge Baluster
- Optional Hollow Baluster Reduces Material Costs (Available For 6' And 8' Level Spans Only)

Patented Racking Stair System

Pre-routed for easy assembly with an innovative Racking Stair detail that accomodates 18° to 40° Rake Angle.

Longer, Code Compliant Spans

Meets International Residential Code (IRC) for spans up to 10 feet on both level and stair rail.

Popular Upgrades for Liberty Rail



Glass Balusters



Decorative Panels



Radius Rail

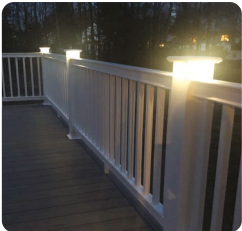

Lighted Newel Caps

Details For All Available Rail Upgrades Start On Page 18

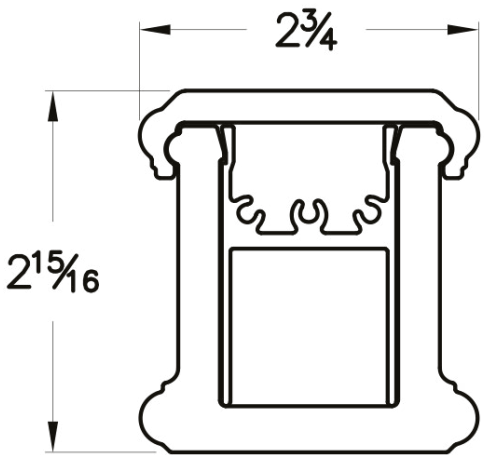

Liberty RS60275 Graspable Flat Top

2-3/4" Liberty is our simple, beverage-friendly profile. This is a popular profile for both level and stair applications.

Price Range: \$ \$ \$ \$

Installation: ✂ ✂ ✂ ✂



RS60 Liberty Kits	6' Length	8' Length	10' Length	12' Length
36" Height	✓	✓	✓	✗
42" Height	✓	✓	✓	✗
Stair Application	✓	✓	✓	✗



GET AN INSTANT QUOTE!
www.intexmillwork.com

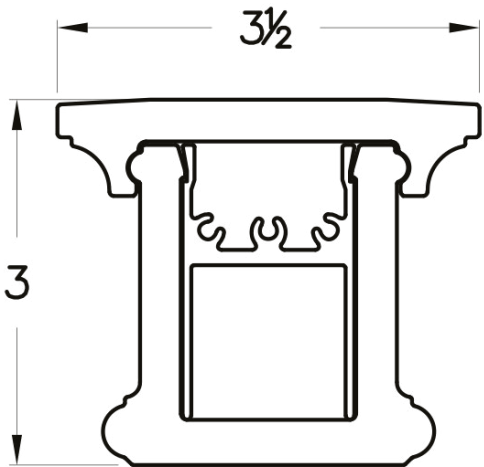

Liberty RS60350 Flat Top with Character

3-1/2" Liberty is our decorative, beverage-friendly profile. This profile is prodominetly used for level rail, in conjunction with 2-3/4" profile on stair applications.

Price Range: \$ \$ \$ \$

Installation: ✂ ✂ ✂ ✂



Hampton Extruded Rail

An Economical Rail Solution with
Performance Superior to Composite Railing



Unique Hampton Rail Features

- Standard Kits Ship With Solid 1 1/4" Square-Edge Baluster
- Mahogany Cap Upgrade Available For Both Hampton Profiles!

Rail Assembly Jig

Our reusable rail assembly jig is designed specifically to help reduce installation times and labor cost. The Assembly Jig makes it easier to align, center and space balusters.

Longer, Code Compliant Spans

Meets commercial requirements of International Building Code (IBC) and International Residential Code (IRC) for level spans up to 10 feet and stair spans up to 8 feet.

Popular Upgrades for Hampton Rail:



Mahogany Top Cap



Decorative Panels



Radius Rail



3-Line Rail

Details For All Available Rail Upgrades Start On Page 18

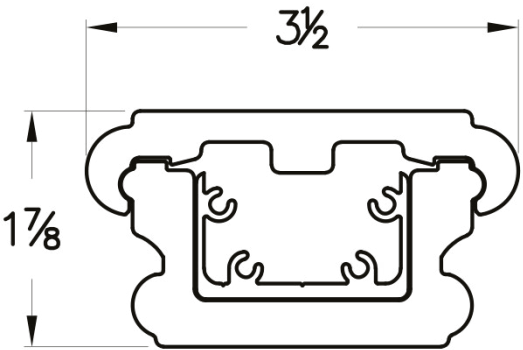

**Hampton RS40350F
Beverage Friendly Top**

Hampton Flat is our most popular profile in a beverage-friendly detail. This profile is available as our standard Cellular PVC flat profile or a Mahogany flat profile upgrade.

Price Range: \$ \$ \$ \$

Installation: ✂ ✂ ✂ ✂



RS40 Hampton Kits	6' Length	8' Length	10' Length	12' Length
36" Height	✓	✓	✓	✗
42" Height	✓	✓	✓	✗
Stair Application	✓	✓	✗	✗



GET AN INSTANT QUOTE!
www.intexmillwork.com

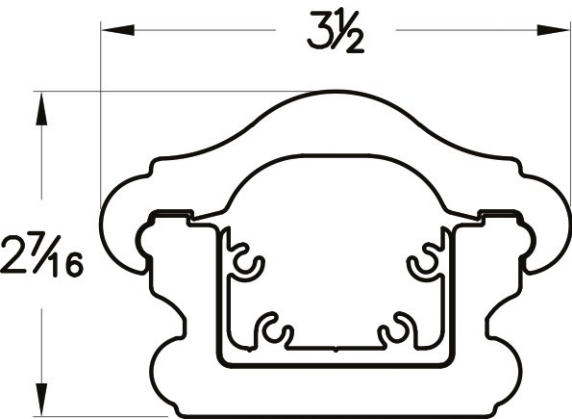

**Hampton RS40350P
Traditional Rail Style**

Our Peaked Hampton profile brings an added touch of historic detail with its rounded design. This profile is available as our standard Cellular PVC peaked profile or a Mahogany peaked profile upgrade.

Price Range: \$ \$ \$ \$

Installation: ✂ ✂ ✂ ✂



Providence Extruded Rail

Durability That Far Surpasses Wood
and Other Traditional Materials!



Unique Providence Rail Features

- Commercially Code Approved For 10’ Level Spans
- Standard Kits Ship With Solid 1 ¼" Square-Edge Baluster
- Available In The New England Area! Contact Your INTEX Sales Representative For More Information

Longer, Code Compliant Spans

Meets commercial requirements of International Building Code (IBC) and International Residential Code (IRC) for level spans up to 10 feet and stair spans up to 8 feet.

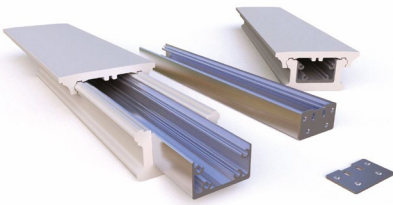

Popular Upgrades for Providence Rail:



Aluminum Reinforced Gates



Decorative Panels



Radius Rail



3-Line Rail

Details For All Available Rail Upgrades Start On Page 18

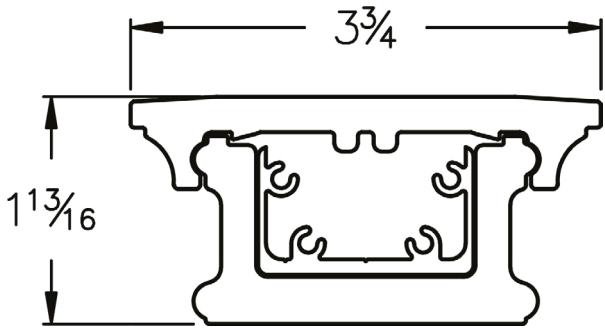
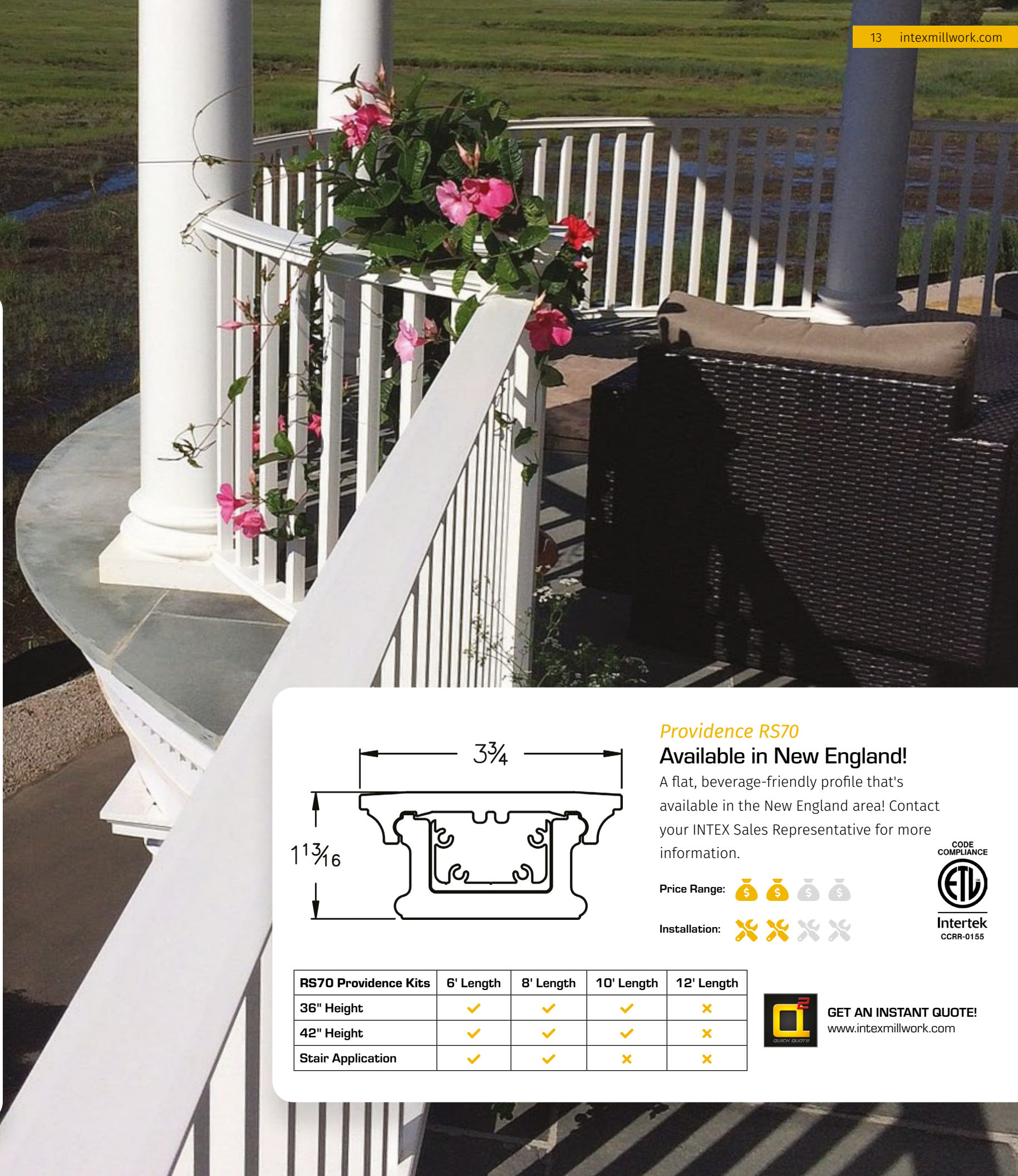

**Providence RS70
Available in New England!**

A flat, beverage-friendly profile that's available in the New England area! Contact your INTEX Sales Representative for more information.

Price Range: \$ \$ \$ \$

Installation: ✂ ✂ ✂ ✂



Intertek
CCRR-0155

RS70 Providence Kits	6' Length	8' Length	10' Length	12' Length
36" Height	✓	✓	✓	✗
42" Height	✓	✓	✓	✗
Stair Application	✓	✓	✗	✗



GET AN INSTANT QUOTE!
www.intexmillwork.com

Dartmouth Extruded Rail

A Classic and Elegant Rail Profile
with Modern Characteristics



Unique Dartmouth Rail Features

- Commercially Code Approved for 12' span
- 12' Spans Contain Heavy-Duty Aluminum
- Standard Kits Ship With Solid 1 1/2" Square-Edge Baluster

Rail Assembly Jig

Our reusable rail assembly jig is designed specifically to help reduce installation times and labor cost. The Assembly Jig makes it easier to align, center and space balusters.

Longer, Code Compliant Spans

Meets commercial requirements of International Building Code (IBC) and International Residential Code (IRC) for level spans up to 12 feet and stair spans up to 8 feet.

Popular Upgrades for Dartmouth Rail:



Louver Infill

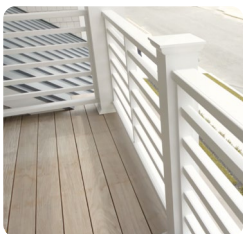

Horizontal Balusters

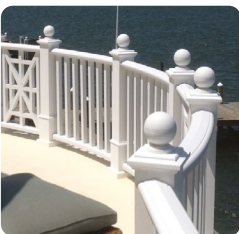

Radius Rail



Glass Panels

Details For All Available Rail Upgrades Start On Page 18

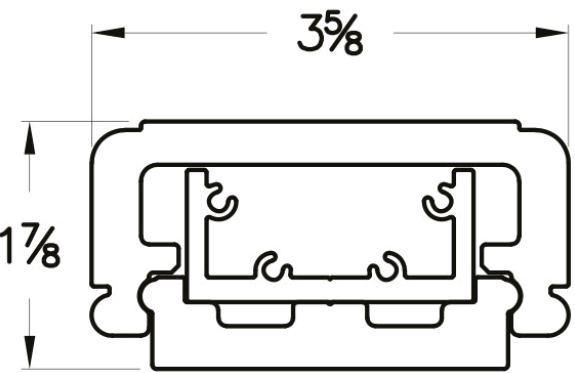
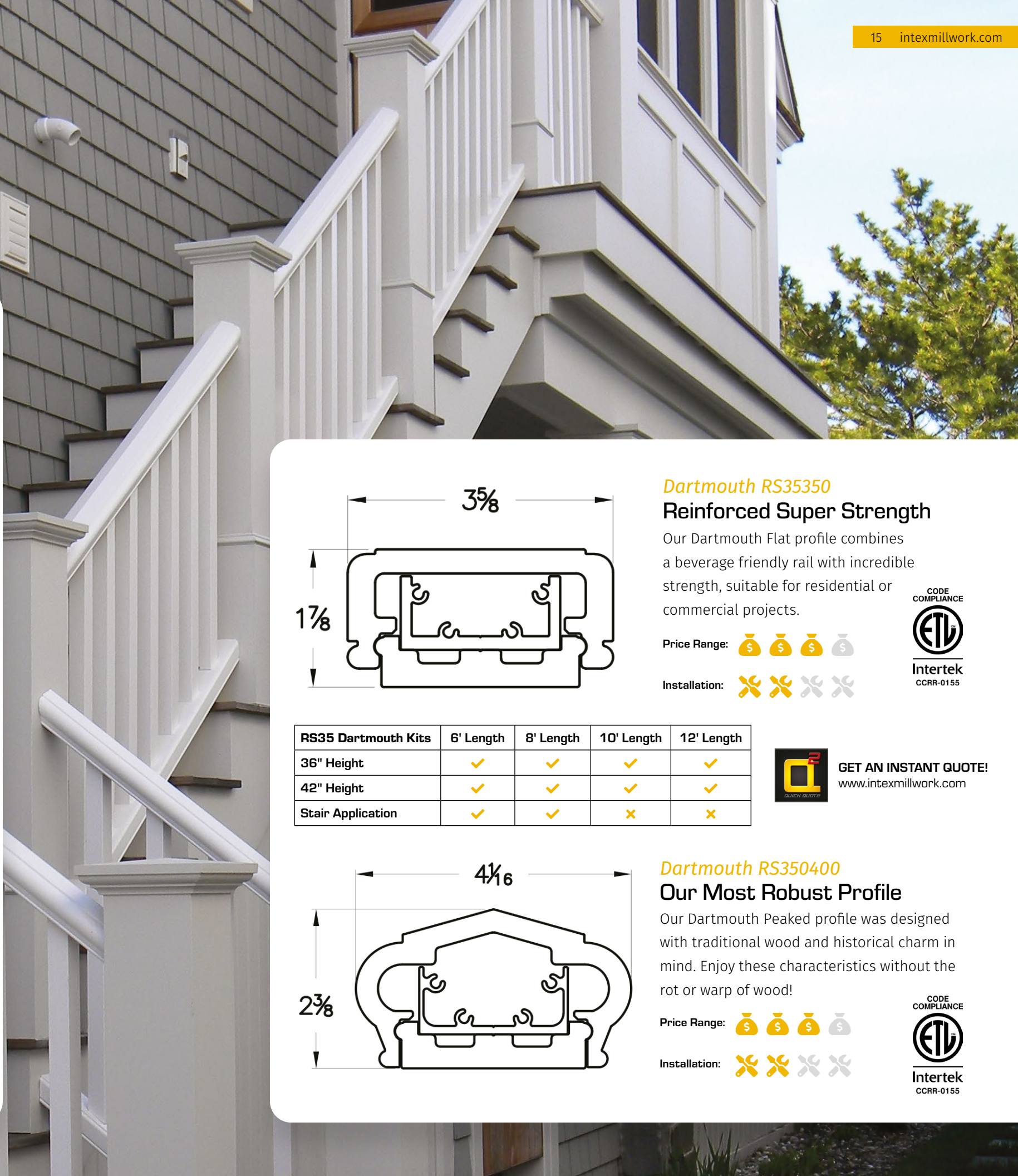

**Dartmouth RS35350
Reinforced Super Strength**

Our Dartmouth Flat profile combines a beverage friendly rail with incredible strength, suitable for residential or commercial projects.

Price Range: \$ \$ \$ \$

Installation: ✂ ✂ ✂ ✂



RS35 Dartmouth Kits	6' Length	8' Length	10' Length	12' Length
36" Height	✓	✓	✓	✓
42" Height	✓	✓	✓	✓
Stair Application	✓	✓	✗	✗



GET AN INSTANT QUOTE!
www.intexmillwork.com

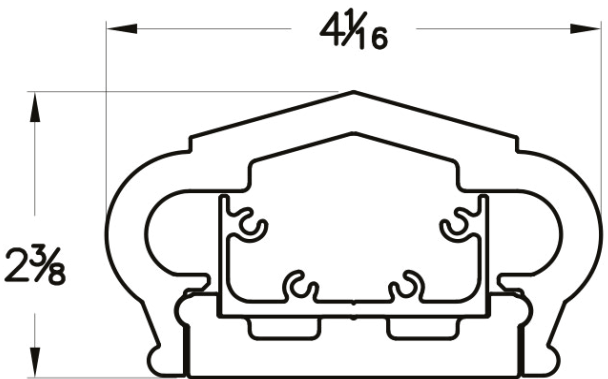

**Dartmouth RS350400
Our Most Robust Profile**

Our Dartmouth Peaked profile was designed with traditional wood and historical charm in mind. Enjoy these characteristics without the rot or warp of wood!

Price Range: \$ \$ \$ \$

Installation: ✂ ✂ ✂ ✂



Nautilus Milled Rail

How to Order Nautilus Custom Rail

Our premier railing system built by craftsmen just like a wood rail would have been made years ago. The components are milled, assembled, hand sanded and then primed, so they are ready for the finish coat of your choice.

- 3-3/4", 5", 6", 7" And 8" Standard Rail Widths
 - Custom Profiles Available
 - Spans Up To 10' For Ibc Level Application
 - Spans Up To 8' For Ibc Stair Application
 - Multiple Newel Cap Styles Available
- Square, Chamfered, Or Turned Balusters Available In Multiple Sizes
 - Painting Required; Paint Must Be Light Reflective Value (LRV) of 55 or Greater

Step 1

Select a Structural Post

☐ INTEX Structural Post Mount

☐ Pressure Treated 4x4

☐ Pressure Treated 6x6

Step 2

Select a Newel Post Wrap Size & Style

☐ NEWEL6.5
Fits 5" Rail or Smaller

☐ Millwork Newels
Newel Width Should Be At Least 1" Larger Than Rail Width. See page 33 for Millwork Newel Sizes and Styles

Step 3

Select a Newel Cap Style

☐ Non-Skirted Newel Cap
Fits all flush and directional paneled newels

☐ Skirted Newel Cap
Fits all flush and panel 4-side newels

Step 4

Select a Rail Profile

☐ Nautilus RS10500

☐ Nautilus RS20500

☐ Nautilus RS50500

☐ Nautilus RS10600

☐ Nautilus RS20700

☐ Nautilus RS20800

Step 5

Select an Infill

☐ Square Baluster (A)

☐ Chamfered Baluster (B)

☐ T1 Turned Baluster (C)

☐ T2 Turned Baluster (D)

☐ Square Decorative Panel

☐ Full Decorative Panel

Step 6

Select Desired Gate(s) and or Upgrades (If Any)

☐ Single Gate

☐ Double Gate

☐ Radius Rail

☐ Mahogany Cap

☐ Glass Balusters

Nautilus Balusters
Standard Nautilus Balusters (shown, right) are available as 1.5", 2", 2.5", 3.5" or 5" widths. Custom balusters are available at all widths and heights.

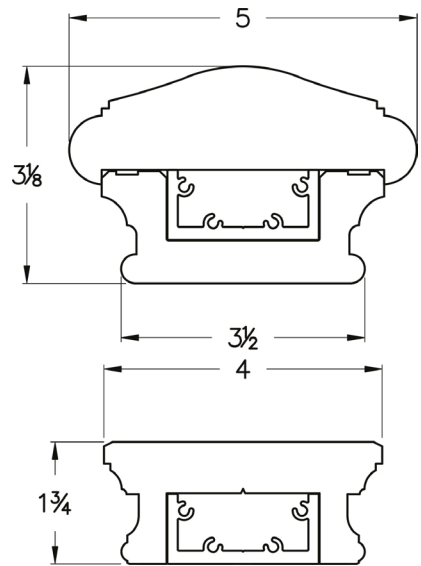
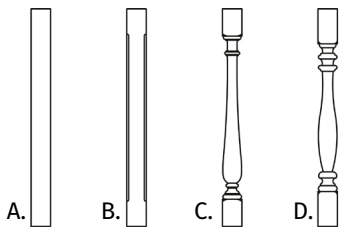

Nautilus RS10500
Works with 2-1/2" Baluster or Smaller

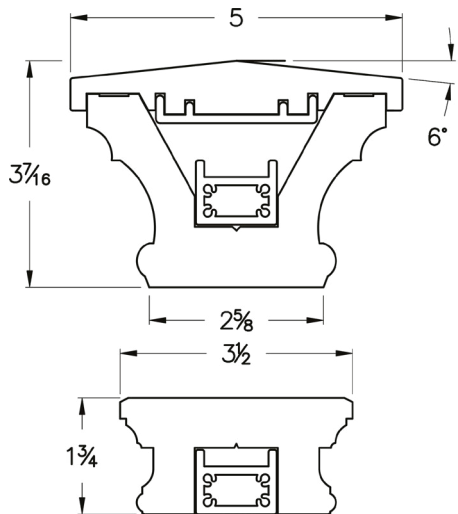

Nautilus RS20500
Works with 2-1/2" Baluster or Smaller

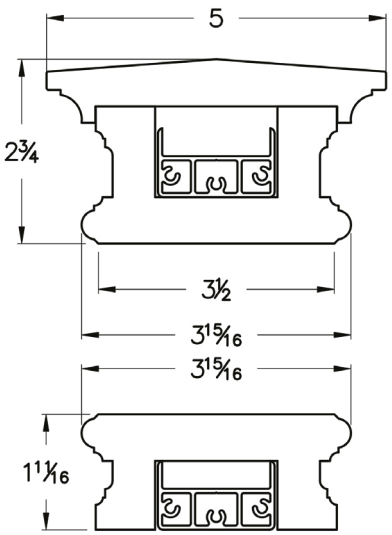

Nautilus RS50500
Available in Gooseneck; Works with 2-1/2" Baluster or Smaller

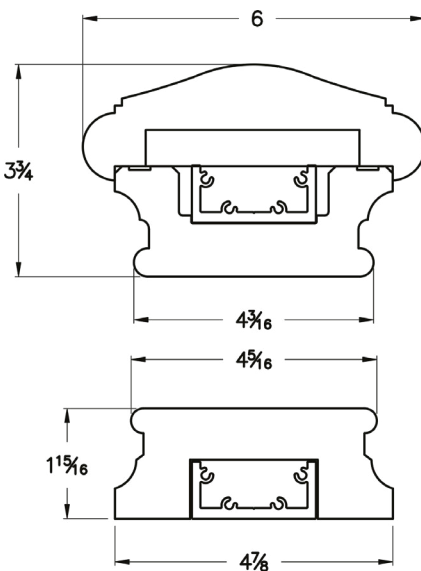

Nautilus RS10600
Works with 3-1/2" Baluster or Smaller

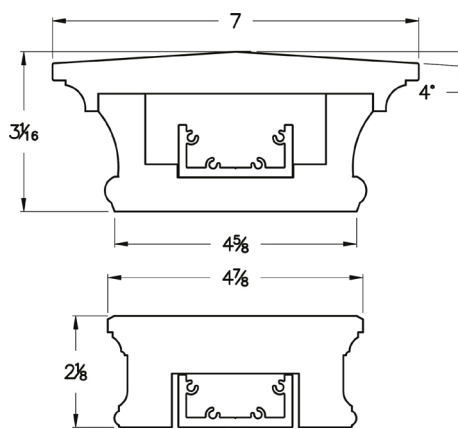

Nautilus RS20700
Works with 3-1/2" Baluster or Smaller

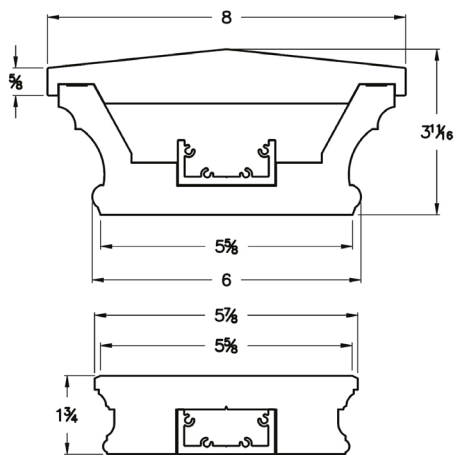

Nautilus RS20800
Works with 5" Baluster or Smaller

All Nautilus Rail	6' Length	8' Length	10' Length	12' Length
36" Height	✓	✓	✓	✗
42" Height	✓	✓	✓	✗
Stair Application	✓	✓	✗	✗



GET AN INSTANT QUOTE!
www.intexmillwork.com

Rail Upgrades

Radius Rail

Guaranteed Custom Radius Fit with Our Radius Rail Template Kit!



Custom In-House Radius Bends

We are proud to offer in-house Radius Rail arcs from 6ft, 8ft, and 10ft rail spans. For stairway applications 6ft and 8ft spans are available

The INTEX Guarantee

We guarantee the Radius Rail fit when the INTEX Radius Rail Template Kit is used. Call 856-293-4100 to order a Radius Rail Template Kit!

Radius Rail Availability

	Level Rail			Stair Rail	
	6'	8'	10'	6'	8'
Liberty	✓	✓	✓	✓	✓
Hampton	✓	✓	✓	✓	✓
Providence	✓	✓	✓	✓	✓
Dartmouth	✓	✓	✓	✓	✓
Nautilus	✓	✓	✓	✗	✗



Scan for Our Video Gallery!
Then scroll to the "Rail Templating"
section for Radius Rail tutorials!

Rail Upgrades

Aluminum-Reinforced Gates

Gates for INTEX Rail Systems are reinforced with aluminum, crafted with no open cells and are available using any of our standard rail profiles. Available as single or double gates. INTEX Gates cannot be trimmed or cut to size.



Liberty Gates



Hampton Gates
Providence Gates



Dartmouth Gates



Nautilus Custom Gates

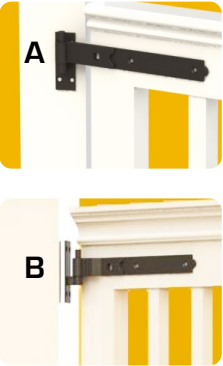

GATE HARDWARE

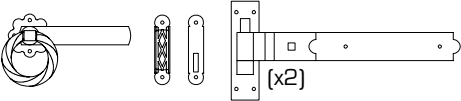

INTEX Rail Gate Mounting Hardware set includes Two 12" Band Hinges, Latch & Stop, all in black.

- A. Face-Mount Hardware Application
- B. In-Line Hardware Application

Rail Upgrades

3-Line Rail



Add an Extra Touch of Style and Character to Your Next Rail Project!



Kits Include Everything You Need!

3 Line Rail Kits include: Horizontal Rails, Structural Reinforcements, Square Balusters, Hardware and Crush Blocks.

	3-Line Rail Availability
Liberty	✗
Hampton	✓
Providence	✓
Dartmouth	✓
Nautilus	✓



Rail Upgrades

Glass Balusters & Panels

Whether it's your waterfront destination, or your countryside escape – INTEX railing with glass balusters combine the beauty and sight lines of an unobstructed view, with the safety of traditional, vertical rail infill.

Glass Balusters

- Available In 6ft & 8ft Lengths, For Level Rail Only
- Not Available For Stair Rail
- Available For 36" & 42" Level Rail
- No Mechanical Fastening Or Field Routing
- Tempered Glass Balusters (1/4" x 3-5/8") Come In Packs Of 5
- Top & Bottom Rails Are Pre-Routed For A Clean Look With Easy Installation
- Enjoy A Beautiful, Unobstructed View That Also Lets In A Cool Breeze!
- Hampton, Providence, Dartmouth, and Nautilus Rail Prepped for Glass Require Applied Routed Channel

	Glass Baluster Availability
Liberty	✓
Hampton	✓
Providence	✓
Dartmouth	✓
Nautilus	✓



Glass Panels

- Enjoy A Beautiful, Unobstructed View!
- Available In 6ft & 8ft Lengths
- INTEX Glass Panel Rail Kits Are Designed To Be Used With 3/8" Thick Tempered Glass Panels, Supplied By Others
- Glass Panel Rail Sets Include Clamps And Associated Hardware To Mount 3/8" Tempered Glass Panel (By Others)
- Specs For 3rd Party Glass Available Through Your INTEX Millwork Sales Rep

	Glass Panel Availability
Liberty	✗
Hampton	✗
Providence	✗
Dartmouth	✓
Nautilus	✗



Rail Upgrades

Standard Decorative Panels



Standard Decorative Panels

- Dress Up Your Curb Appeal By Adding Decorative Panels To Your INTEX Rail!
- Available For Level, Stair And Radius Rail Applications
- Choose From 5 Standard Designs, Available As 36" Or 42" Heights
- Standard Decorative Panels For Liberty, Hampton, Providence, And Dartmouth Come Pre-Finished And Do Not Require Paint, But Can Be Painted With A Light Reflective Value (LRV) Of 55 Or Greater
- Standard Nautilus Decorative Panels Require Paint; Light Reflective Value (LRV) Of 55 Or Greater



Type 1



Type 2



Square Web

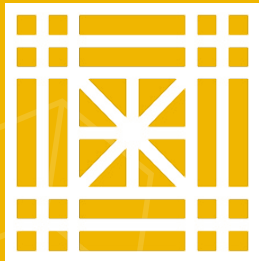

Prairie



Global

Standard Decorative Panels	
Liberty	✓
Hampton	✓
Providence	✓
Dartmouth	✓
Nautilus	✓

Rail Upgrades

Custom Decorative Panels

If You Can Draw It, We Can Make It!



Custom Decorative Panels

- Dress Up Your Railing Project Even Further!
- Available For Level, Stair And Radius Rail Applications
- Standard Pricing For All Typical Or Custom Decorative Panels
- Choose From Our Library Of Custom Panels, Or Create Your Own
- Available As A Square Panel Or Full Infill Panel
- Custom Decorative Panels For Liberty, Hampton, Providence, And Dartmouth Come Pre-Finished And Do Not Require Paint, But Can Be Painted With A Light Reflective Value (LRV) Of 55 Or Greater
- Custom Nautilus Decorative Panels Require Paint; Use A Light Reflective Value (LRV) Of 55 Or Greater



Scan to see our library of Custom Decorative Panel Examples!

	Liberty	Hampton	Providence	Dartmouth	Nautilus
Custom Decorative Panels	✓	✓	✓	✓	✓

Rail Upgrades

Louver & Horizontal Baluster Infills

Both Louver and Horizontal Baluster Infills are fast and easy installations due to pre-routed, vertical stanchions and easily trimmable sizes that create custom fits.

Louver Infill

- Why You Want It: Greater Privacy While Maintaining Airflow To Your Deck Or Porch
- How It Ships: As Trimmable Kits At 6', 8', And 10' Level Sections Only, for 36" or 42" High Rail
- Custom Heights Also Available

	Louver Infill Availability
Liberty	✗
Hampton	✓
Providence	✓
Dartmouth	✓
Nautilus	✗



Horizontal Baluster Infill

- Why You Want It: For A More Contemporary Or Modern Design Without The Cost, Labor, Or Maintenance Of Alternative Horizontal Infills
- How It Ships: As Trimmable Kits At 6', 8', And 10' Level Sections Only, For 36" Or 42" High Rail
- Custom Heights Also Available

	Horizontal Balusters Availability
Liberty	✗
Hampton	✓
Providence	✓
Dartmouth	✓
Nautilus	✗



Rail Accessories

Transition Kits

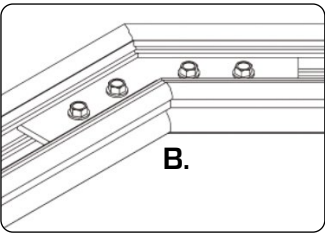
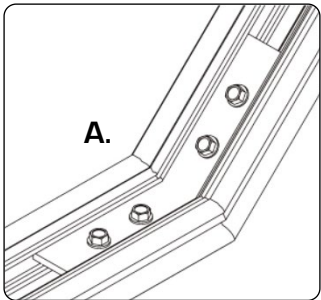
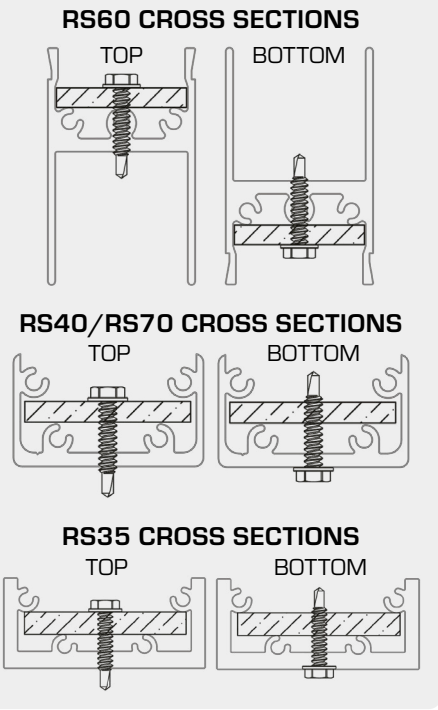

- A. In-Line Rail Elevation Change, Adjustable (Not At A Newel)**
Adjustable by bending to the required angle, and will change the rail direction up or down.
- B. Level Rail Direction Change 45° Or 90° (Not At A Newel)**
Used to change rail direction within the span, while leaving the connections to the newel(s) flush.

- Liberty, Hampton, & Providence Rail Transition Brackets Are 0.1875" Thickness, Dartmouth Rail Transition Brackets Are 0.25" Thickness
- All Brackets Are Symmetrical About Dashed Lines
- All Through Holes Are Ø0.25" (Sized For #10 Screws)

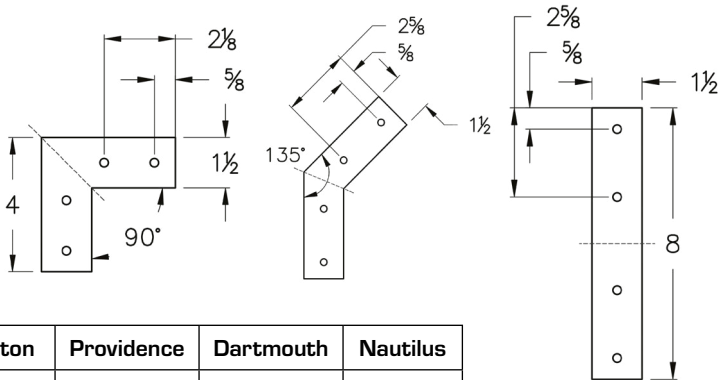

	Liberty	Hampton	Providence	Dartmouth	Nautilus
Transition Kits	✓	✓	✓	✓	✓

Resources

Web & Social Media

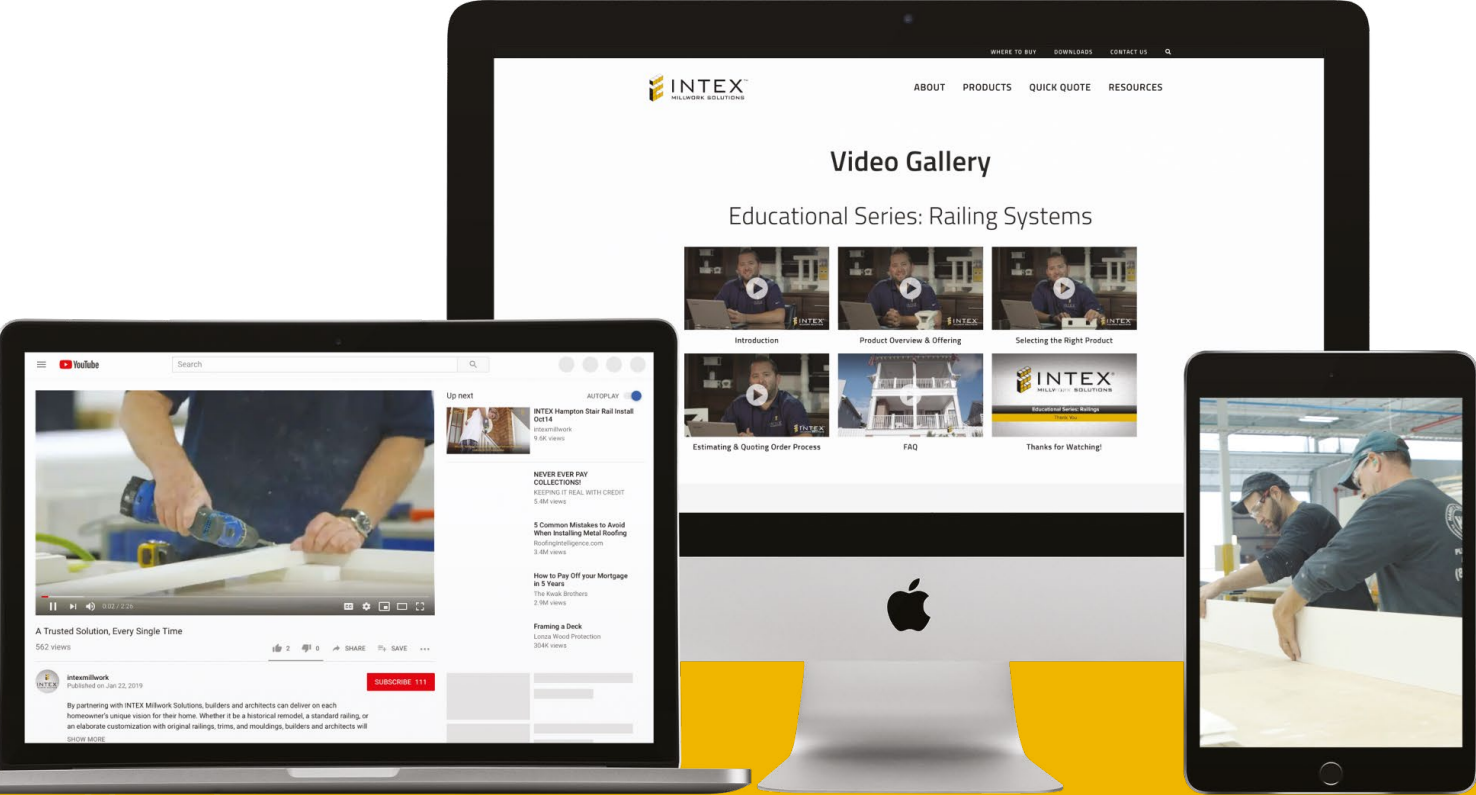

INTEXMILLWORK.COM RESOURCES

- Additional Brochures & Marketing Material PDFs
- Painting & Cleaning Guide
- INTEX Product Warranties
- Quick Quote Tools For Railing, Columns, Newels, Pergola & Trellis Systems, Window Surrounds, Custom Mouldings
- Installation & Product Videos
- Installation PDFs
- Architectural Files
- BIM Revit Family Library & More!



Scan To Visit Our Resources Page

SOCIAL MEDIA

Find and follow @intexmillwork on your favorite Social Media channels for the latest updates on INTEX Products!

Use #intexmillwork for a chance to be featured on our channels, website, or even in our catalog!



Scan To Visit Our BIM Library



Scan To Visit Our Video Gallery



Scan To Visit Our Architects Page

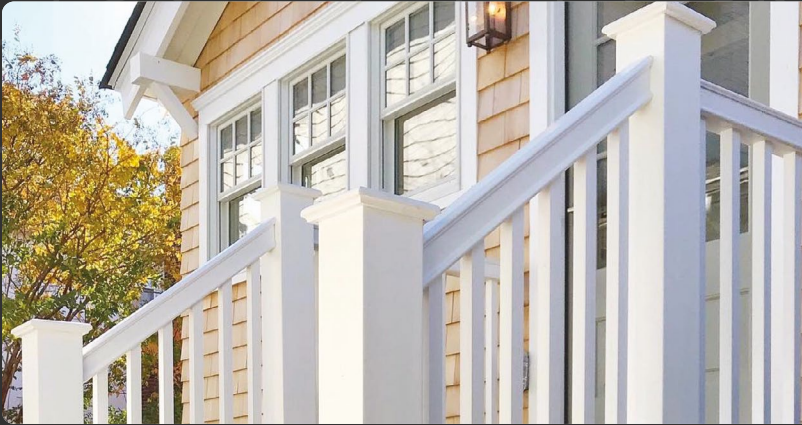

Extruded 5" Newels
Our most common Newel Post, extruded as one piece and provides all the value of Cellular PVC at our lowest price point. Pairs with our most affordable lids and base trim.

Price Range: \$ \$ \$ \$

Installation: ✂ ✂ ✂ ✂



Fabricated 5" & 6.5" Newels
Our mid-range Newel offering provides a hand-built newel with even sharper corners and a more traditional feel.

Price Range: \$ \$ \$ \$

Installation: ✂ ✂ ✂ ✂



Millwork Newels
When only the finest will do, our Millwork Newels provide a variety of sizes and panel options for the greatest of curb appeal.

Price Range: \$ \$ \$ \$

Installation: ✂ ✂ ✂ ✂



Custom Newels
When a standard dimension post just won't do, we can design a post to your exact specification.

Price Range: \$ \$ \$ \$

Installation: ✂ ✂ ✂ ✂



Section 02

Newel Wraps

Common Features

Newel & Column Wraps

Wrapped in stylish designs, newels and columns can do double duty as both vital architectural components and dramatic visual elements. Homes adorned with columns and newels convey a feeling of timeless strength and beauty.

All INTEX Newel & Column Wraps:

- 100% Cellular PVC
- Multiple Style Options Available – Flat, Recessed, Raised, Or Chamfered
- Used With Existing Structural Members Or Used In Stand-Alone Non-Structural Applications
- Split Pedestal Options Are Available
- Compatible With All INTEX Rail Systems
- Custom Newel And Column Wraps Can Be Created To Meet Your Design Requirements Or For Historic Restoration
- Do Not Require Paint, But Can Be Painted With A Light Reflective Value (LRV) Of 55 Or Greater

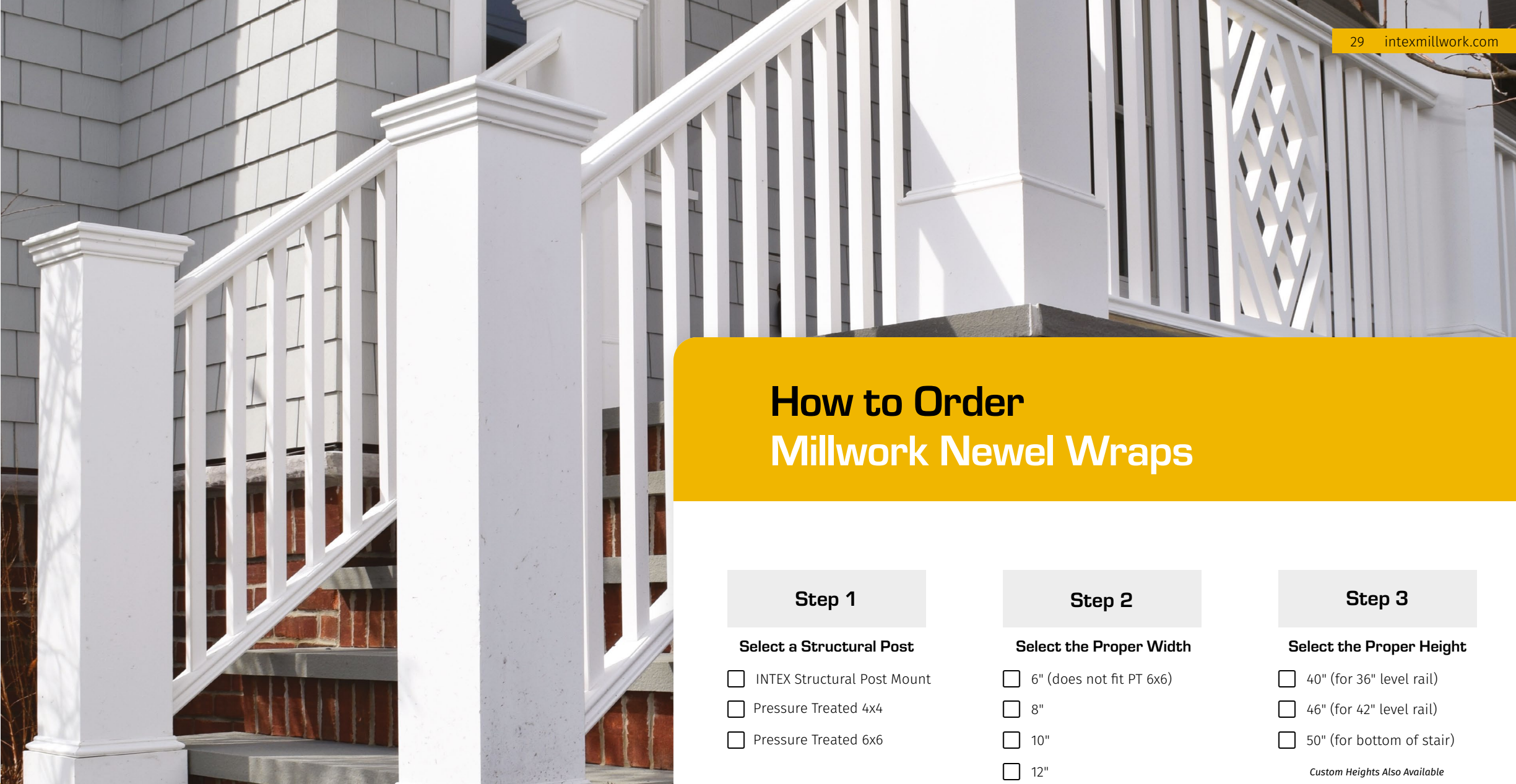

How to Order Millwork Newel Wraps

Step 1

Select a Structural Post

- ☐ INTEX Structural Post Mount
- ☐ Pressure Treated 4x4
- ☐ Pressure Treated 6x6

Step 2

Select the Proper Width

- ☐ 6" (does not fit PT 6x6)
- ☐ 8"
- ☐ 10"
- ☐ 12"

Custom Sizes Also Available

Step 3

Select the Proper Height

- ☐ 40" (for 36" level rail)
- ☐ 46" (for 42" level rail)
- ☐ 50" (for bottom of stair)

Custom Heights Also Available

Step 4

Select a Panel Detail

- ☐ Flush
- ☐ Recessed
- ☐ Recessed with Inlay
- ☐ Raised
- ☐ Chamfered

Refer To Page 33 For Panel Details

Step 5

Select the Panel Orientations

- ☐ Panel 4 Side
- ☐ Line
- ☐ Corner
- ☐ End

Refer To Drawings On Previous Page For More Information

Step 6

Select the Cap Style & Size

Skirted Caps (For Panel 4 Side)

- ☐ NTC-S40
2 Tier Flat Cap with Skirt
- ☐ NPTC-S40
Pyramid Cap with Skirt

Non-Skirted Caps (For Line Corner End)

- ☐ NTC
2 Tier Flat Cap
- ☐ NPTC
Pyramid Cap

For More Newel Cap Styles See Page 34

Short Panel 4-Sides vs Line, Corner, and End Newels

- Short Panel 4-Side Newels Are Predominantly Designed For Skirted Newel Caps (Top Rail Dies Into Skirt, Not Newel Face)
- Short Panel 4-Side Can Be Used When The Supplier Doesn't Know Newel Locations, But It Is Not Recommended (Inferior Detail)
- Skirted Newel Lids Cannot Be Used With Line, Corner, And End Newels
- Line, Corner, And End Newels Are Designed To Give A Full Panel Detail On Non-Rail Side And Flush Panel Face On Rail Side

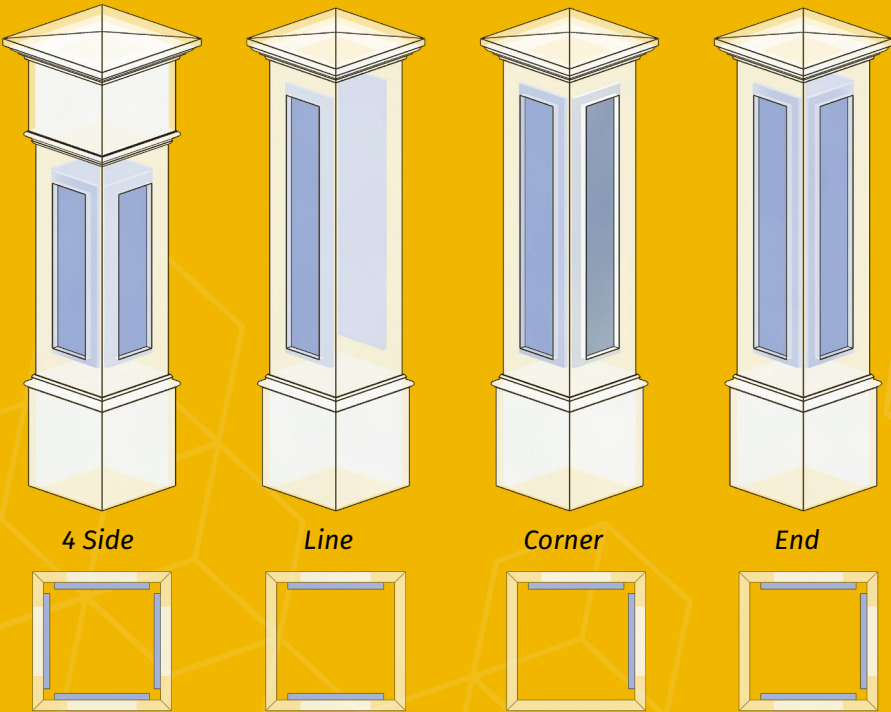

Newel Wraps Structural Post



Post-Mount & Hardware

- Structural Post System Requires 2 Items To Complete
- NEWELPOST36/42 (Structural Post) **Along With One Of The Following:**
 - NEWELMOUNT-W (Through Bolt Detail) **OR**
 - NEWELMOUNT-C (Lag Bolt Detail)
- Includes #10 x 1-1/2" Rail Attachment Screws For Proper Fastening Of Rail To Post
- Works For Both 36" & 42" Rail Heights
- Includes Injection Molded Compression Shims For Easy Use With NEWEL5 & NEWEL5-EX
- Salt Spray Tested For Coastal Application



GET AN INSTANT QUOTE!
www.intexmillwork.com

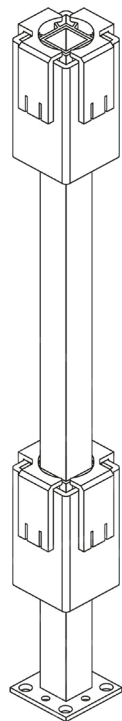

NEWELPOST36/42
POST MOUNT WITH GUIDES

	Liberty	Hampton	Providence	Dartmouth	Nautilus
Structural Posts	✓	✓	✓	✓	✓

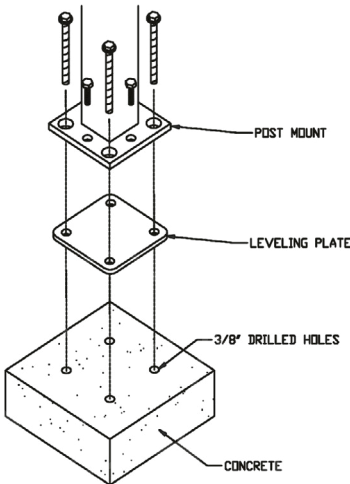

NEWELMOUNT-C
POST MOUNT HARDWARE KIT
FOR CONCRETE APPLICATION

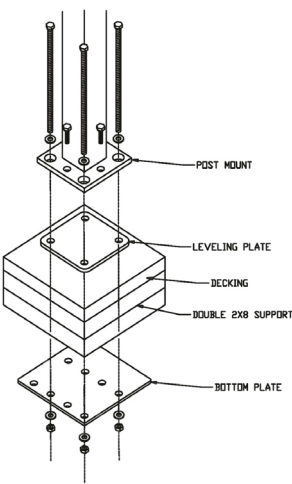

NEWELMOUNT-W
POST MOUNT HARDWARE KIT
FOR WOOD APPLICATION

Newel Wraps Extruded & Fabricated Newel Wraps with Lids & Bases



GET AN INSTANT QUOTE!
www.intexmillwork.com



*IMPC5 works with
NEWEL5-EX & NEWEL5*



*NCFLAT5 works with
NEWEL5-EX & NEWEL5*

*NCFLAT6.5 works
with NEWEL6.5*



*NCPYRAMID5 works with
NEWEL5-EX & NEWEL5*

*NCPYRAMID6.5 works
with NEWEL6.5*



*NCHAR5 works with
NEWEL5-EX & NEWEL5*

*NCHAR6.5 works
with NEWEL6.5*



*NEWEL5-EX
with IMPC5 & IMTR5*



*NEWEL5
with NCFLAT & NBTR5*



*NEWEL6.5
with NCPYRAMID & WM75*

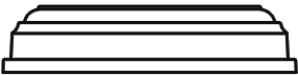

*IMTR5 works with
NEWEL5-EX & NEWEL5*



*NBTR5-EX works with
NEWEL5-EX only*



*NBTR5 works with
NEWEL5 only*



*NBTR6.5 works with
NEWEL6.5 only*

Newel Accessories

Lighted Newel Caps

Easy to Install System

- Available For 5" Newels Only
- Available As Flat Cap or Pyramid Cap
- Easy Plug Installation System Cuts Installation Time in Half vs. Traditional Cap Lighting Systems
- System Includes Necessary "Do It Yourself" Items to Light Each Post:
 - One Transformer Style & Size (150 Watt; Can Support Up To 50 Newels)
 - Timer & "Dusk to Dawn Photo Eye" Included

Energy Efficient Lighting

- Down-Lit System With LED Recessed Under The Newel Cap Gives A Clean Look
- 80% Energy Efficient Vs. Traditional Cap Lighting Systems
- Low Voltage DC System Means No Permits Or Electrician Required To Install



GET AN INSTANT QUOTE!
www.intexmillwork.com

	Lighted Newel Cap Availability
Liberty	✓
Hampton	✓
Providence	✓
Dartmouth	✓
Nautilus	✗

Newel Wraps

Millwork Newel Wraps

Millwork Newel Wraps are shipped fully assembled and ready to be incorporated with structural components — typically a 4 x 4, 6 x 6, or a Structural Post Mount — for installation.



GET AN INSTANT QUOTE!
www.intexmillwork.com

Before Ordering, Please Note:

- 40" Newels Are For Use With 36" Level Rails
- 46" Newels Are For Use With 42" Level Rails
- 50" Newels Are For Use At The Bottom Of Stairs

Inside Clearance

Newel Size	3/8" Flat	5/8" Flat, Raised, or Chamfered	Recessed or Recessed with Inlay
6"	5-1/4"	4-3/4"	4" at Center, 4-3/4" at Top & Bottom
8"	7-1/4"	6-3/4"	6" at Center, 6-3/4" at Top & Bottom
10"	9-1/4"	8-3/4"	8" at Center, 8-3/4" at Top & Bottom
12"	11-1/4"	10-3/4"	10" at Center, 10-3/4" at Top & Bottom

Actual Footprint Includes Base Wrap

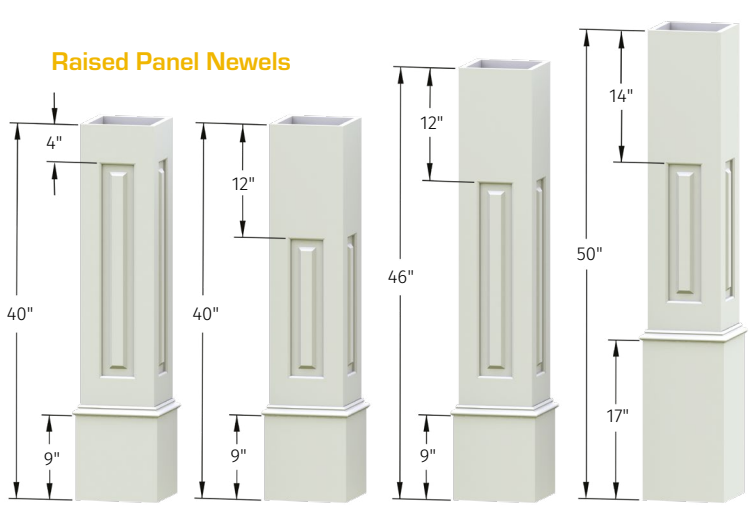
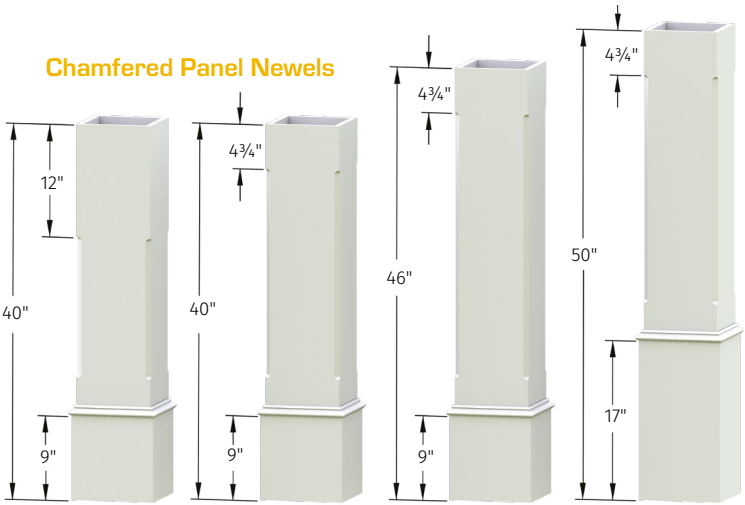
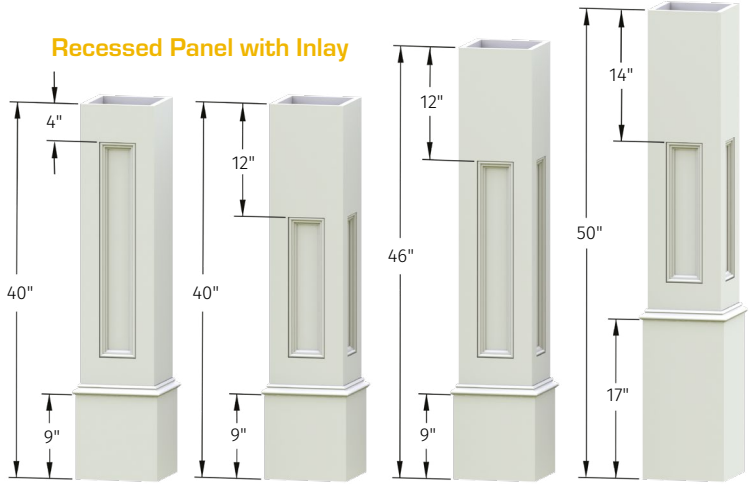
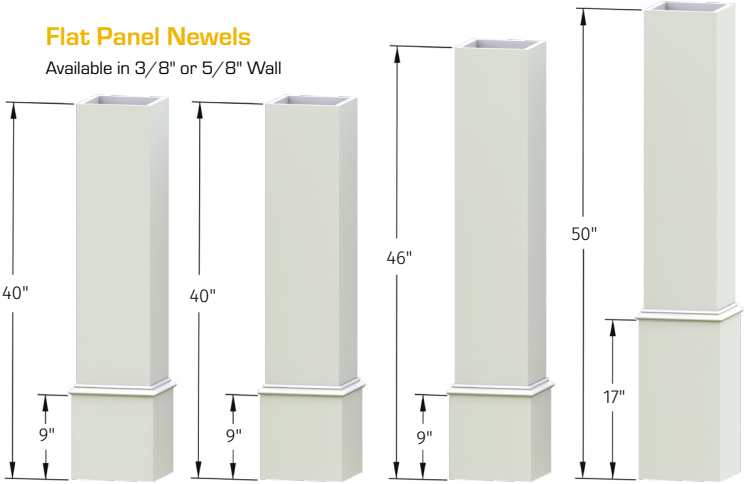
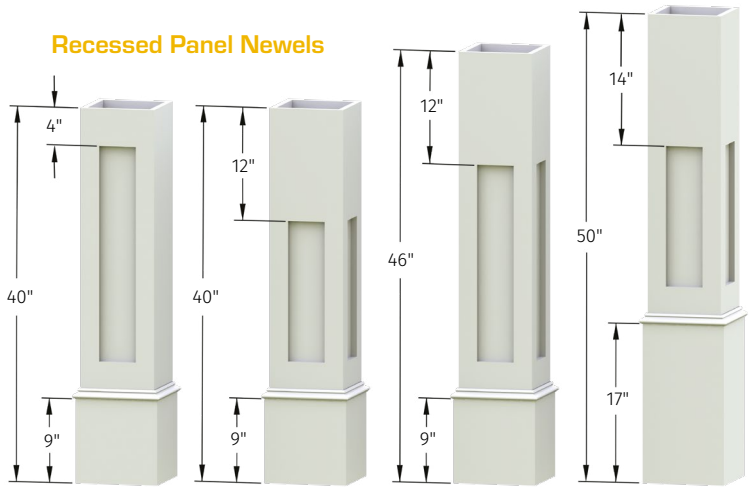

	Flat	Chamfered	Recessed	Recessed with Inlay	Raised
Line, Corner, or End Configuration	✗	✗	✓	✓	✓

Newel Wraps Cap Styles



Choose From Our Selection of Standard Newel Caps, Nantucket Newel Caps, or Design Your Own!



Standard Newel Caps

- All Standard Newel Caps Are Available As 6", 8", 10", And 12"
- Larger Standard & Custom Sizes Are Available Upon Request
- All Flat Top Caps Are Available With Ball Finial
- Visit intexmillwork.com For Newel Cap Item Numbers And Pricing

Nantucket Newel Caps

Our Nantucket Newel Cap product series provides you with over 100 newel cap styles to choose from. Nantucket Newel Caps are designed to fit all INTEX standard newel post wraps sizes 5", 6", 8", 10" and 12". Larger standard & custom sizes are available upon request.



Scan, or visit intexmillwork.com to see over 100 Nantucket Newel Cap styles and options!

Standard Newel Cap Styles:

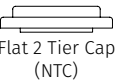

Flat 2 Tier Cap (NTC)

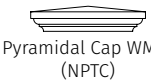

Pyramidal Cap WM75 (NPTC)

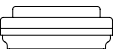

2 Tier Plain Cap With 287 Rake Trim (NTCR)

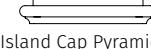

Island Cap Pyramidal (NICP)



3 Tier Cap WM75 Trim (NTTC)

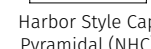

Harbor Style Cap Pyramidal (NHC)

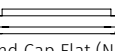

Island Cap Flat (NICF)



Triton Cap (NTCT)

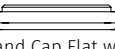

Island Cap Flat with Chamfer (NICFC)



Pyramidal Cap With Skirt For 40" - 46" Newels (NPTC)

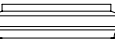

Harbor Cap Flat (NHCF)



Pyramidal Cap With Skirt For 50" Newels (NPTC)



Harbor Cap Flat with Chamfer (NHFCF)

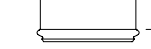

3 Tier Cap With Skirt For 40" - 46" Newels (NTTC)

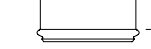

3 Tier Cap With Skirt For 50" Newels (NTTC)

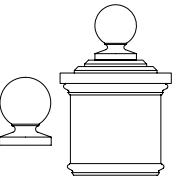

All Flat Top Caps Are Available With Ball Finial; Add "B" To The End Of The Product Code

Newel Wraps Custom Newels

We offer the ability to create Custom Newel wraps to meet your design requirements or for historic restoration!

Custom Newel Examples

- Multi-Sided Newels
- Directional Newels
- Rectangular Newels
- Turned Newels
- Historical Recreations

Email quotes@intexmillwork.com To Quote Your Custom Newel Project!



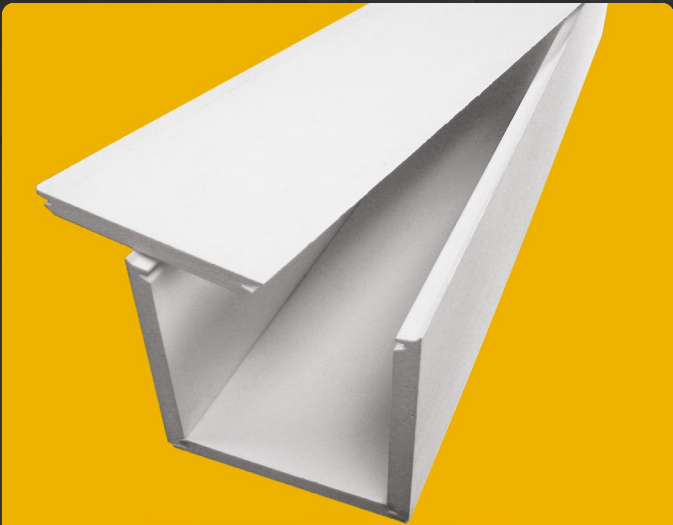

Easy Wraps

Whether you want the most affordable, Knocked Down, shaft only or the pre-assembled system including cap and base, Easy Wrap has a solution for covering your pressure treated or cedar posts.

Price Range:

Installation:



Builder Wraps

For a better alternative to Fiberglass columns, use our Builder Wrap at the architectural size of your choice.

Price Range:

Installation:



Millwork Column Wraps

When only the finest will do, our Millwork Column Wraps provide a variety of sizes and panel options for the greatest of curb appeal.

Price Range:

Installation:



Custom Column Wraps

Whether you need Tapered Columns and Pedestals or Turned Porch Posts, our Custom Column Wraps can fit any design requirements.

Price Range:

Installation:



Section 03
Column Wraps



How to Order Column Wraps

Step 1

Select Structural Post

INTEX Column Wraps Are Non-Structural

- ☐ Pressure Treated 4x4
Works With All INTEX Columns
- ☐ Pressure Treated 6x6
Does Not Fit 6" Column
- ☐ Pressure Treated 8x8
Does Not Fit 6" or 8" Column

Step 2

Select the Proper Width

Custom Column Widths Also Available

- ☐ 6" Column
Does Not Fit Over PT 6x6
- ☐ 8" Column
Does Not Fit Over PT 8x8
- ☐ 10" Column
- ☐ 12" Column

Step 3

Select the Proper Height

Custom Column Heights Also Available

- ☐ 8' Column
- ☐ 9' Column
- ☐ 10' Column
- ☐ 12' Column

Step 4

Select the Panel Detail

- ☐ Flush Panel
- ☐ Recessed Panel
- ☐ Recessed Panel with Inlay
- ☐ Raised Panel
- ☐ Chamfered

Step 5

Select the Panel Orientations

- ☐ Panel 4 Side
- ☐ Split Panel 4 Side
- ☐ Line, Corner, End

See Previous Page For Details

Step 6

Select Cap & Base Style

- ☐ Style H Standard (Included)
- ☐ Style A
- ☐ Style B 164 BC
- ☐ Style C 75 BED
- ☐ Style D 163 CROWN
- ☐ Style E 49 CROWN
- ☐ Style F WM97 CASING

Panel 4-Side vs. Split Panel 4-Side vs. Line, Corner, End

- Panel 4-Side Does Not Make Accomodation For Rail Mounting
- Split Panel 4-Side Has Check Rail For Rail Mounting (Standard Check Rail Height To Accomodate 36" Rail, All Other Heights Must Be Custom Quoted)
- Line, Corner, & End Columns Have Full Panel On Non-Rail Side, And No Panel On Rail Side

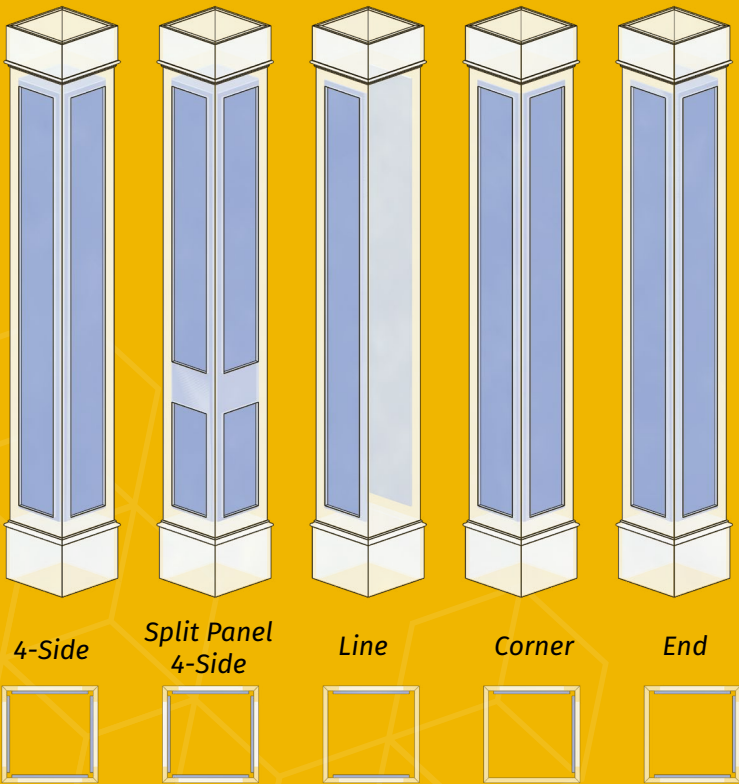

Column Wraps Knocked Down Easy Wraps

Our Most Affordable Column Wrap!



Knocked Down Easy Wrap Sample Display as 4 Flat Pieces



Knocked Down Easy Wrap Sample Display Fully Assembled

Knocked Down Easy Wraps

- Our Most Affordable Column Wrap!
- 100% Cellular PVC
- Available Widths: 4 1/2", 5", 6 1/2", 7", 8 1/2" & 9"
- Available Heights: 96", 108" And 120"
- Available In Celuka Or Free Foam
- Arrives As 4 Flat Pieces For Quick & Easy Installation - No Fasteners Required!
- Cap And Base Sold Separately
- Does Not Require Paint, But Can Be Painted With A Light Reflective Value (LRV) Of 55 Or Greater

INTEX's Easy Wrap Post Wrap options are economical and easy to install. Save money in product and labor cost by using these innovative post wrap systems!



GET AN INSTANT QUOTE!
www.intexmillwork.com



Column Wraps Assembled Easy Wraps



Assembled Easy Wraps

- Fastest Column Installation Available!
- 100% Cellular PVC
- Available Widths: 4 1/2", 5", 6 1/2", 7", 8 1/2", & 9"
- Available Heights: 96", 108", & 120"
- Includes 2 Trim Rings
- Arrives 3 Sides Assembled for Quick & Easy Snap-Together Installation!
- Does Not Require Paint, But Can Be Painted with a Light Reflective Value (LRV) of 55 or Greater



GET AN INSTANT QUOTE!
www.intexmillwork.com



Column Wraps

Millwork Column Wraps

Column Wraps are shipped in two halves and ready to be incorporated with structural components — typically a Pressure Treated 4 x 4, 6 x 6, or 8 x 8 — for installation.

BUILDER SERIES
& FLAT PANEL



CHAMFERED

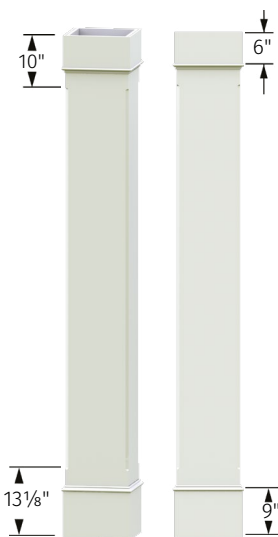

RECESSED
PANEL

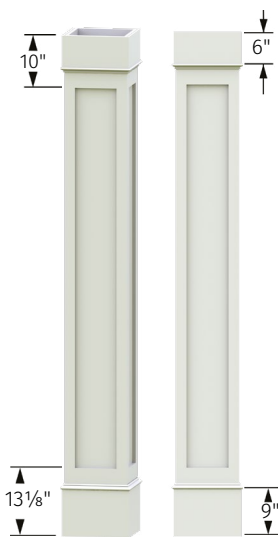

RECESSED SPLIT
PANEL



RECESSED PANEL
WITH INLAY

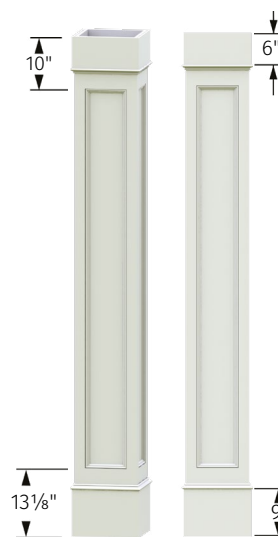

RECESSED PANEL
WITH INLAY SPLIT



RAISED
PANEL

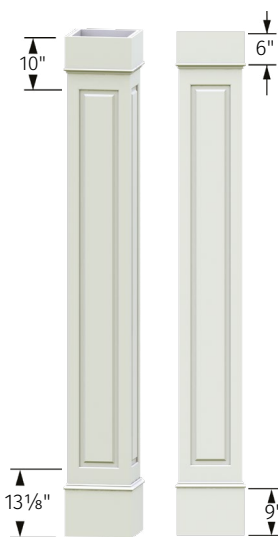

RAISED PANEL
SPLIT



Column Wraps

- Standard Widths: 6", 8", 10", & 12"
- Standard Heights: 8', 9', 10', & 12'
- Custom Widths & Heights Also Available



GET AN INSTANT QUOTE!
www.intexmillwork.com

Column Size	Builder Series (3/8" Wall)	Plain, Raised or Chamfered	Recessed or Recessed with Inlay
6"	5-1/4"	4-3/4"	4" at Center, 4-3/4" at Top & Bottom
8"	7-1/4"	6-3/4"	6" at Center, 6-3/4" at Top & Bottom
10"	9-1/4"	8-3/4"	8" at Center, 8-3/4" at Top & Bottom
12"	11-1/4"	10-3/4"	10" at Center, 10-3/4" at Top & Bottom

	Flat	Chamfered	Recessed	Recessed with Inlay	Raised
Line, Corner, or End Configuration	×	×	✓	✓	✓

Column Wraps

Custom Columns

We offer the ability to create Custom Column wraps to meet your design requirements or for historic restoration!

Tapered Columns

- Flush, Recessed Panel, Recessed with Inlay, Raised Panel, Chamfered, And Custom Designs Available
- Available in 12"-8", 16"-12", 20" - 14", And Custom Widths
- Available in 5', 6', 8', & Custom Heights
- WM75 Cap & Base Included
- Upgraded & Custom Caps & Bases Available
- Ships in "L Halves" And Includes Adhesive
- Do Not Require Paint, But Can Be Painted With A Light Reflective Value (LRV) of 55 or Greater



GET AN INSTANT QUOTE!
www.intexmillwork.com



Pedestal Base

- Available In 12", 16", 20" Or Custom Sizes
- Standard Heights Available At 40" Or 46"
- Flush, Recessed Panel, Recessed With Inlay, Raised Panel, Chamfered, And Custom Designs Available



GET AN INSTANT QUOTE!
www.intexmillwork.com



Custom Columns

- Multi-Sided Columns
- Directional Columns
- 1/3 - 2/3 Entasis Columns
- Turned Columns
- Historical Recreations

Email quotes@intexmillwork.com To Quote Your Custom Column Project!





Classic Pergolas

Classic Pergolas come in standard sizes to give your project all the architectural charm of a traditional wooden pergola, at the lowest cost.

Price Range: [1 yellow bag icon] [3 grey bag icons]

Installation: [1 yellow wrench icon] [3 grey wrench icons]



Deluxe Pergolas

Deluxe Pergolas offer the perfect blend of value and customization for your next project. When stock sizes just won't do, choose Deluxe.

Price Range: [2 yellow bag icons] [2 grey bag icons]

Installation: [2 yellow wrench icons] [2 grey wrench icons]



Premium Pergolas

If you need industry leading engineering and spans, our Premium Pergolas are the perfect choice for you.

Price Range: [3 yellow bag icons] [1 grey bag icon]

Installation: [3 yellow wrench icons] [1 grey wrench icon]



Custom Pergolas

Do you have an original pergola design you want to make a reality? Let our Custom Pergolas bring your dreams to life.

Price Range: [4 yellow bag icons]

Installation: [4 yellow wrench icons]



Section 04 Pergola Systems

Common Features

Pergola Sytems

Freestanding in a garden, gracing a patio or surrounding a hot tub, a pergola creates a dramatic architectural statement. INTEX Pergola Systems are as strong as they are beautiful, and designed for a secure, easy installation. Enjoy your new outdoor oasis in as little as a weekend.

All INTEX Pergola Systems:

- Low Maintenance 100% Cellular PVC With Aluminum Reinforced Core
- Aluminum Core And Brackets Will Not Rust Or Corrode
- Complete Bracket System For Every Installation With Stainless Steel Screws
- Economical Systems Available
- Multiple Pergola Tail Designs To Choose From
- Do Not Require Paint, But Can Be Painted With A Light Reflective Value (LRV) Of 55 Or Greater

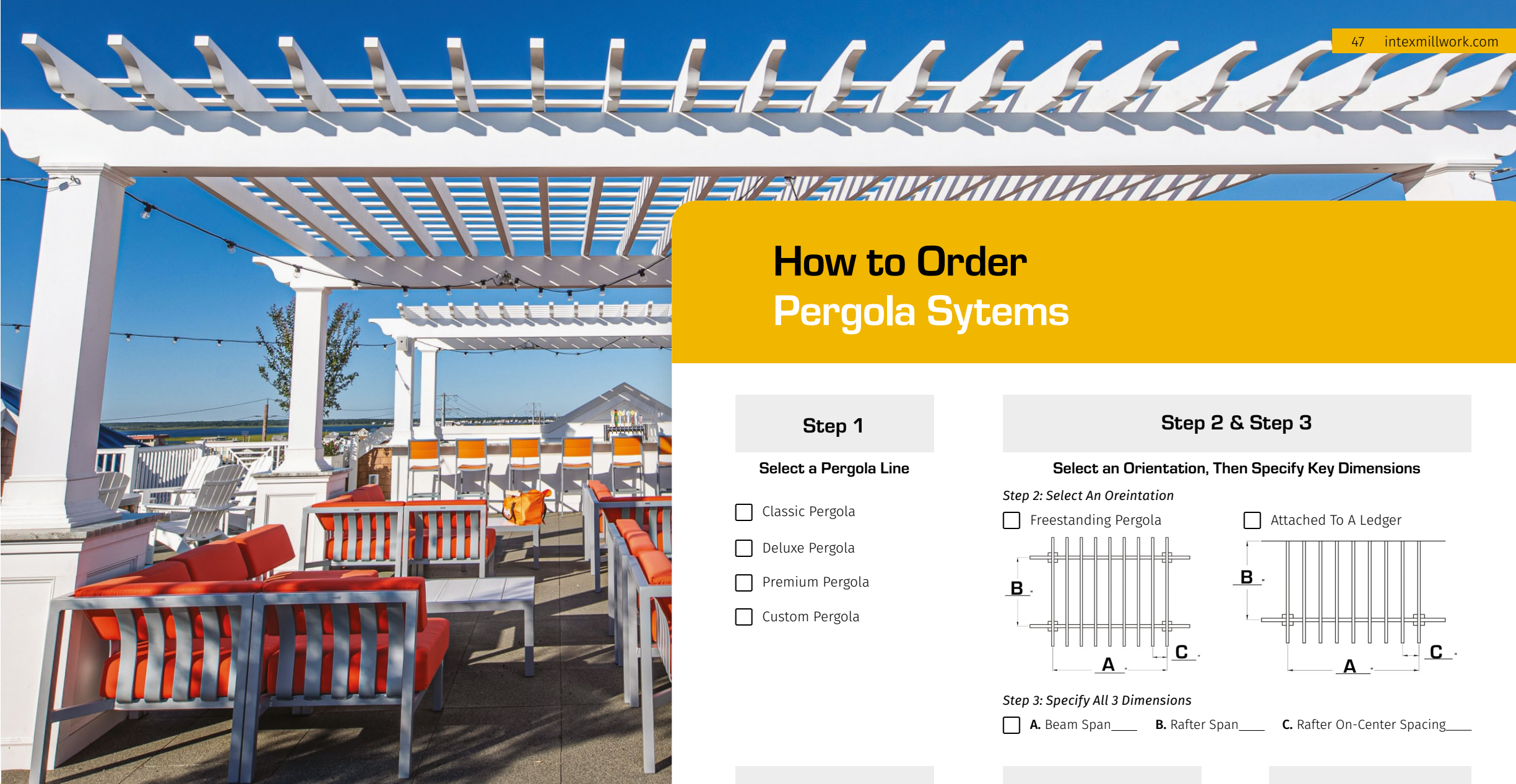

Pergola Systems Comparison

	Classic	Deluxe	Premium	Custom *
Rafter Size Options	1	1	2	3
Beam Size Options	1	1	4	4
Maximum Clear Spans	14' x 14'	14' x 14'	25' x 25'	25' x 25'
Design Strength				
Custom Lengths		✓	✓	✓
Custom Design Options		✓	✓	✓
Standard Tail Designs	4	6	9	9
Custom Tail Designs			✓	✓
Engineered to International Building Code Requirements			✓	✓
Bend to Radius				✓
Price				

**INTEX Millwork Solutions Custom Pergola System is available for projects that need to go beyond the limits of our Premium Pergola System.*

How to Order

Pergola Sytems

Step 1

Select a Pergola Line

- ☐ Classic Pergola
- ☐ Deluxe Pergola
- ☐ Premium Pergola
- ☐ Custom Pergola

Step 2 & Step 3

Select an Orientation, Then Specify Key Dimensions

Step 2: Select An Oreintation

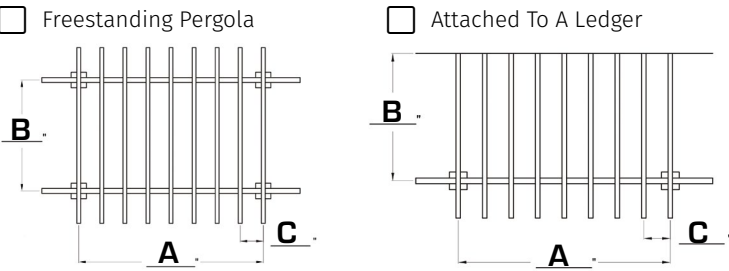

Step 3: Specify All 3 Dimensions

☐ A. Beam Span____ ☐ B. Rafter Span____ ☐ C. Rafter On-Center Spacing____

Step 4

Select Lath Detail

- ☐ 5/4 x 3 Flat Lath
- ☐ 1-1/2" Square Lath
- ☐ 2" x 4" Hollow Purlin with Tails

Step 5

Select Column Detail

All INTEX Pergolas Require A Footing Detail For Structural Purposes, See Installation Instructions For Details

- ☐ Pressue Treated 6x6 with INTEX Column Wrap
- ☐ Pressue Treated 8x8 with INTEX Column Wrap
- ☐ Structural Fiberglass Column by Others

See Page 42 For Column Styles

Step 6

Select a Tail Design

Available For All Pergola Lines

- ☐ PT1
- ☐ PT2
- ☐ PT3
- ☐ PT4

Available for Deluxe, Premium, or Custom

- ☐ PT5
- ☐ PT6

Available for Premium or Custom

- ☐ PT7
- ☐ PT8

- ☐ PT9

Available for Custom

- ☐ Custom Tail Design



GET AN INSTANT QUOTE!
www.intexmillwork.com

Classic Pergola System

All the Architectural Charm of a Traditional Wooden Pergola, at Our Lowest Cost!



The Classic Kit is an economical pergola system designed for small backyard projects. The Classic Kit gives you a quick off-the-shelf solution for your freestanding or attached to structure pergola project.

- One Rafter Size
- One Beam Size
- Standard Sizes Only (8ft, 10ft, 12ft & 14ft Post Centers)
- Lightweight Design
- Economically Priced
- Clear Spans Up To 14' X 14'
- Modest Rafter And Beam Profile
- Four Standard Tail Designs

Classic Pergola Tail Styles

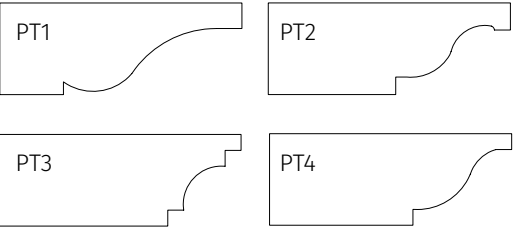

GET AN INSTANT QUOTE!
www.intexmillwork.com



Classic Pergola Examples



Deluxe Pergola System

A High Quality Pergola System
With Options That Can Be Customized



The Deluxe Pergola is the perfect finishing touch for your outdoor living space!

- One Rafter Size
- One Beam Size
- Custom Lengths And Multiple Design Options
- Larger Dimension Components For A Traditional Wood Frame Look
- Moderately Priced
- Clear Spans Up To 14' X 14'
- Larger Rafter & Beam Profile Than Classic Kit
- Six Standard Tail Designs

Deluxe Pergola Tail Styles

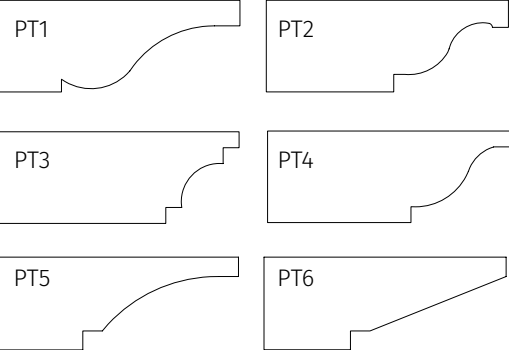

GET AN INSTANT QUOTE!
www.intexmillwork.com

Deluxe Pergola Examples



Premium Pergola System

The Premium Pergola Allows You To Customize Your Pergola To Meet Your Project Specifications!



The substantial design of the Premium Pergola System is engineered to meet international building code for commercial and residential applications.

- Two Rafter Sizes
- Four Beam Sizes
- Custom Lengths And Multiple Design Options
- Larger Rafter And Beam Profile Than Deluxe
- Engineered To Meet The Requirements Of The International Building Code For 1" Ice Load, 120 Mph Wind Up-Lift (Not All Examples Pictured Are Engineered Pergolas)
- Clear Spans Up To 25' X 25'
- Heavy Duty Engineered Design

Premium Pergola Tail Styles

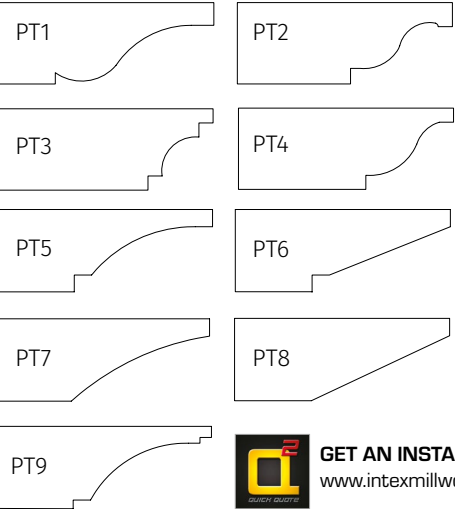

GET AN INSTANT QUOTE!
www.intexmillwork.com

Premium Pergola Examples



Custom Pergola System

Let Our Custom Pergola Systems Bring Your Outdoor Living Dreams To Life!



Custom Pergola Features

- Custom Layouts And Footprints Available
- Clear Spans Up To 25' X 25'
- Standard And Custom Beam, Rafter, And Lath Sizes Available
- Radius Beams & Rafters
- Arched Rafters
- Gable Rafters
- Design Your Own Custom Tail Profile!

Email quotes@intexmillwork.com To Quote Your Custom Pergola Project!

Design a Custom Tail or Choose From Our 9 Standard Styles:

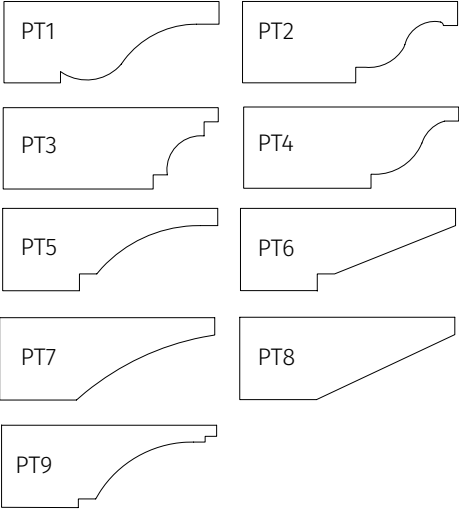

The INTEX Difference

INTEX cellular PVC pergola components are sleeved over structural aluminum internal reinforcements to provide strength and durability. Truly the finishing touch that stands the test of time.



Wooden Pergola - Before



Pergola Recreated by INTEX

Trellis Systems

Boasting Fine Craftsman Style and Gorgeous Architectural Details



Classic Trellis

- Fixed Beam Spans –8', 9' 10', 12', 14'
- 17 3⁄8" x 16 1⁄2" x 3" Bracket
- 2" x 5 1⁄2" Beam
- 1 1⁄2" x 1 1⁄2" x 17 3⁄8" Purlins
- 4 Tail Styles (PT1 - PT4)

Deluxe Trellis

- Custom Beam Spans Up to 16'
- 29 5⁄8" x 30 x 5 1⁄2" Bracket
- 2 1⁄2" x 7 3⁄16" Beam
- 2" x 4" x 32" Purlins
- 9 Tail Styles (PT1 - PT9), Or Create A Custom Tail Design

Trellis Tail Styles

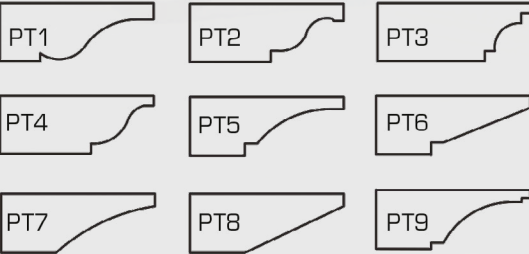

GET AN INSTANT QUOTE!
www.intexmillwork.com

How to Order Trellis Sytems

Step 1

Select a Trellis Line

- ☐ Classic Trellis
- ☐ Deluxe Trellis

Step 2

Select Number of Structural Brackets

- ☐ 2 Brackets Only
- ☐ More Than 2 Brackets

Step 3

Specify Key Dimension

- ☐ Bracket Center to Bracket Center Dimensions

Step 4

Select Purlin Detail

Available For Classic or Deluxe

- ☐ 1 1⁄2" Square

Available For Deluxe Only

- ☐ 2 x 4 Purlin with Tail

Step 5

Select a Trellis Tail Design

Available For Classic or Deluxe

- ☐ PT1
- ☐ PT2
- ☐ PT3
- ☐ PT4

Available for Deluxe Only

- ☐ PT5
- ☐ PT6
- ☐ PT7
- ☐ PT8
- ☐ PT9
- ☐ Custom Tail Design





Estate Fence

Top-of-the-line, strong features highlight the dignified form of the square picket Estate Series. Estate is offered in four standard profiles with complimentary gates. Architectural details provide an extension of your home to the outside of your property.

Available Now

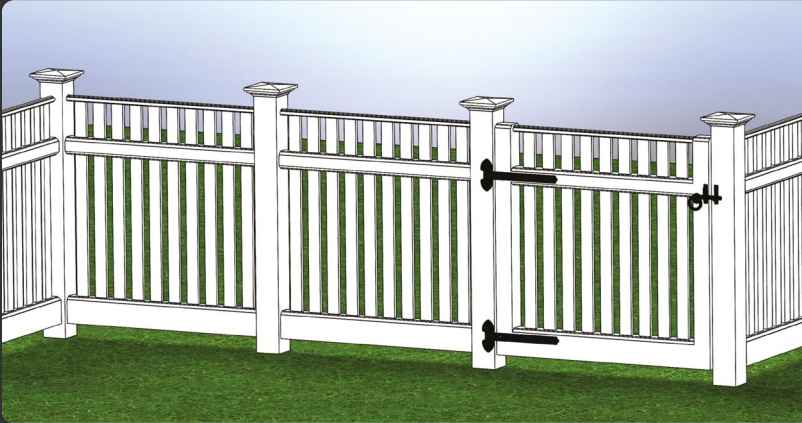

Cottage Fence

Our mid-range series offers subtle elegance in a traditional New England style picket fence. Eight standard profiles provide a charming framework to gardens and pathways.

Call 856-293-4100
For Availability



Serenity Fence

Serenity captures it all with this privacy fence offering. From 6’ solid to solid portions with adorning lattice toppers, the Serenity series will provide solitude and security with a decorative touch.

Call 856-293-4100
For Availability



Custom Fence

When standard just won't do, you can mix and match components from our standard fence series, or plan your own fence style!

Available Now



Section 05
Fence Systems

How to Order
FS10 Estate Fence

Step 1

Select An FS10 Style

- ☐ Style 1
- ☐ Style 2
- ☐ Style 3
- ☐ Style 4

See Page 61 For FS10 Style Drawings

Step 2

Select The Proper Height
And Section Length

- | | |
|------------------------------|------------------------------|
| Height: | Length: |
| <input type="checkbox"/> 36" | <input type="checkbox"/> 48" |
| <input type="checkbox"/> 42" | <input type="checkbox"/> 72" |
| <input type="checkbox"/> 48" | <input type="checkbox"/> 96" |
| <input type="checkbox"/> 60" | |

Step 3

Select Post Cap Style

- ☐ Style 1
- ☐ Style 2
- ☐ Style 3

Step 4

Select Gate Options

- Gate Type:
- ☐ Single Gate (Up to 5' W x 5' H)
 - ☐ Double Gate (Up to 10' W x 5' H)
- Gate Style:
- ☐ G1 ☐ G4
 - ☐ G2 ☐ G5
 - ☐ G3

See Page 61 For FS10 Gate Drawings

Step 5

Create A Detailed Layout
& Include The Following
Critical Information

- ☐ Level or Varying Grade?
- ☐ Draw And Dimension Any Pathways That Will Be Gated
- ☐ Dimensions On Layout To Be Post Centers

Step 6

Submit Completed Fence
Layout to INTEX

- ☐ Submit Layout to quotes@intexmillwork.com

Layout Example

The Fence Layout You Create Should Look Similar To The Example Shown Here. Be Sure To Include And Label All Information Requested In The Steps Above.

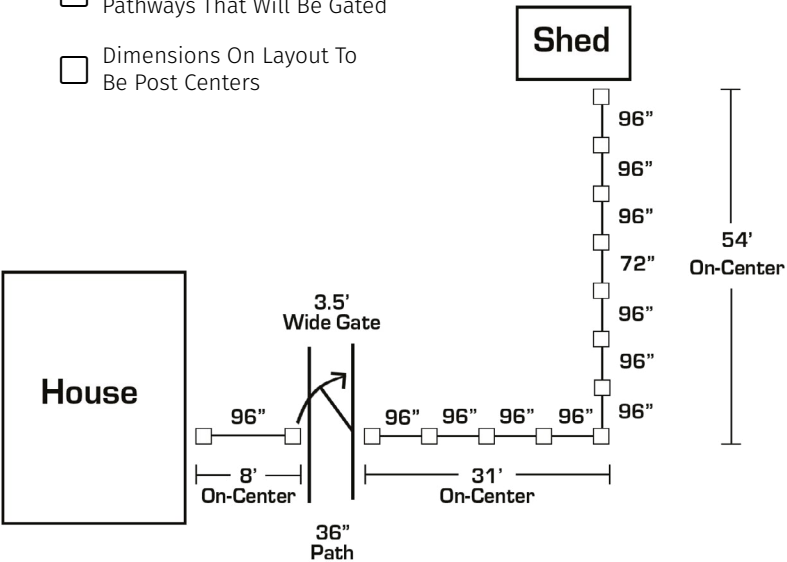

Fence Systems

Estate Series

Add A Delicate Accent To A Garden, Or Surround An Estate With Prominent Architectural Features!



Estate Fence Features

- 100% Cellular PVC
- Available In A Variety Of Styles And Sizes
- Reinforced Aluminum Core For Strength & Corrosion Resistance
- Gates Structurally Reinforced With Welded Frame
- Aesthetically Pleasing Shadow Lines
- Rackable Or Stepped For Grade Adjustment
- Low Maintenance And Easy To Clean
- Does Not Require Paint, But Can Be Painted With A Light Reflective Value (LRV) Of 55 Or Greater

Ease of Installation

We combine prominent profile features with a simple drop-together installation with minimal on-site tool requirements and hidden fasteners.

Visit intexmillwork.com For Estate Fence Pricing!

Exceptional Strength

- A. Aluminum reinforced top and bottom rails for fence sections.
- B. Two part post reinforcement for applications including gates, in-line reinforcement, and masonry or hard substrate mounting.
- C. Exploded view of structurally reinforced gate.

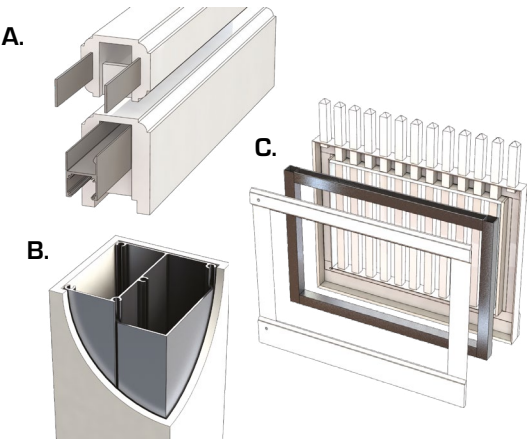

Estate Style Options

The Estate Series is available in four unique styles for fence section, and five styles for gates. All Gates are available as double-swing.

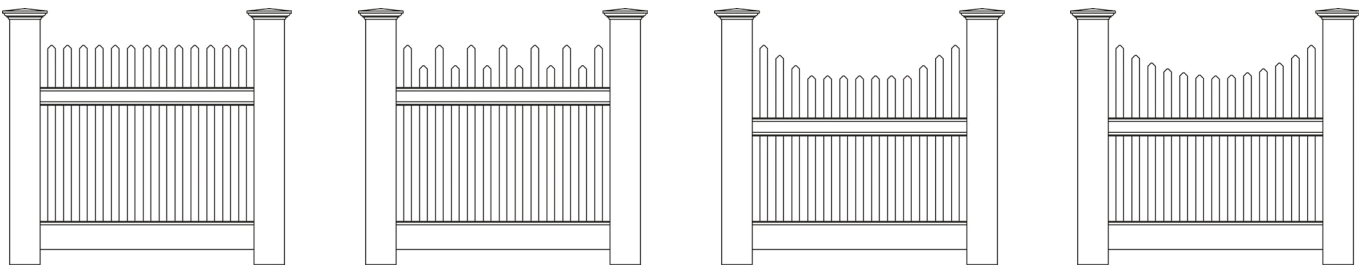

Style 1

Style 2

Style 3

Style 4

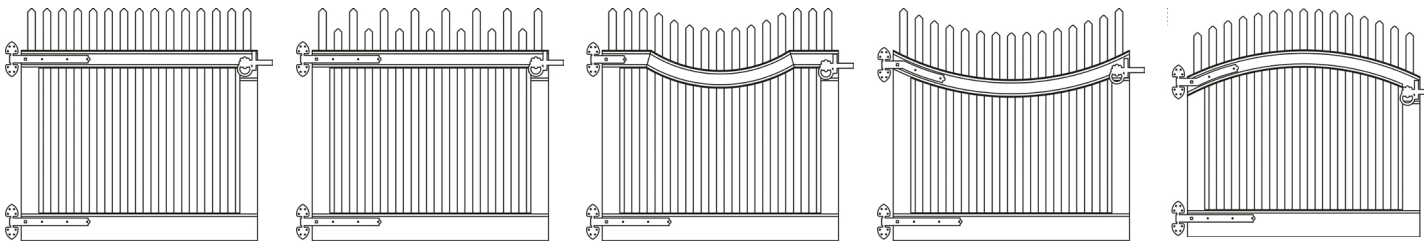

Gate Style 1

Gate Style 2

Gate Style 3

Gate Style 4

Gate Style 5

Fence Systems

Custom Fence



When Standard Fence Styles Just Won't Do, You Can Create Your Very Own INTEX Fence Style!



Custom Fence Capabilities

- Mix & Match Standard INTEX Components For Semi-Custom Profiles
- Many Custom Capabilities Available
- Contact Quotes@intexmillwork.com To Start Your Custom Fence Project Today!



Landscape Millwork

From Shower Enclosures to Mailbox Posts and Planter Boxes, we offer Landscape Millwork products in many designs, shapes and sizes. These elements will complement your yard or terrace with lasting charm!



Shutters

Engineered to out-perform wood, polypropylene, polyethylene and aluminum shutters. Choose from 11 pre-finished colors, or finish them yourself!



Window Surrounds, Entry Systems, Moulding & Trim

A home isn't finished until it's dressed in a style all its own. Accentuate your home's existing architecture by working with our Design Team to create custom designs or to meet historic renovation requirements.



Custom Millwork & More

Traditionally renovating a historic home used to be challenging due to custom woodworking which would rot with time. Now, we have a solution with custom PVC millwork.



Landscape Millwork

Shower Enclosures



Complete Your Outdoor Oasis With A Low-Maintenance Shower Kit!

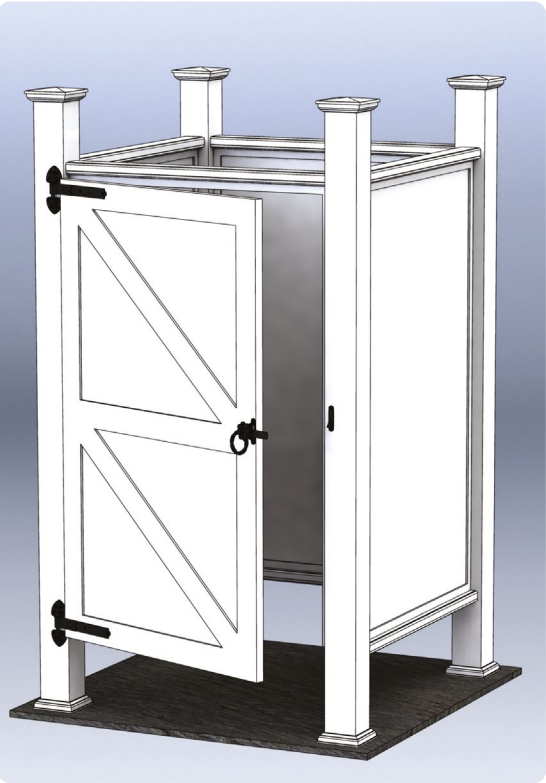

Shower Enclosure Features

- 100% Cellular PVC
- Available In Open Or Closed Back
- Complete Kits Available
- Beaded (Left Image) Or Flush (Right Image) Detail Wall Panels
- Reinforced Aluminum Core For Strength & Corrosion Resistance
- Low Maintenance And Easy To Clean
- Do Not Require Paint, But Can Be Painted With A Light Reflective Value (LRV) Of 55 Or Greater

Standard Shower Enclosure Kit Sizes

- 4' x 4' Open Back Kit
- 4' x 4' Closed Back Kit
- 4' x 8' Open Back Kit
- 4' x 8' Closed Back Kit

Custom Shower Enclosures

Custom layouts are available by request.

Visit intexmillwork.com For Shower Enclosure Pricing!

Landscape Millwork

Boxes & Posts

Window Boxes

- Standard Heights Available At 9" H x 11 ¼" Projection
- Standard Widths Available At 32", 36", 40"
- Standard Panel Details Of Flush, Recessed, Recessed With Inlay, & V-Groove
- 3 Standard Styles Of Support Brackets Available
- Custom Size Boxes And Support Brackets Available Upon Request



Planter Boxes

- Standard Heights & Depths Available At 12", 14", 16", 18"
- Standard Widths Available At 30", 40", 46"
- Standard Square Planters Available At 16" x 16" x 16" & 18" x 18" x 18"
- Standard Panel Details of Flush, Recessed, Recessed with Inlay, & V-Groove
- Custom Size Boxes Available Upon Request



Deluxe Mailbox Posts

- Deluxe 5" x 5" Mailbox Post Includes Arm, Decorative Bracket, Mailbox Plate, & Post Cap
- Mailbox Base Adders Available as Smooth Panel, Recessed Panel, & Recessed Panel With Inlay

Deluxe Lamp Posts

- Deluxe 5" x 5" Lamp Post Includes Flat Cap
- Lamp Post Base Adders Available As Smooth Panel, Recessed Panel, & Recessed Panel With Inlay
- Cap Includes A 3" Diameter Collar For Mounting Lantern
- Cap & Post Pre-Drilled For Wiring
- Optional 24" Sign Arm Available



Millwork & More Shutters

Engineered To Out-Perform Wood, Polypropylene, Polyethylene And Aluminum Shutters

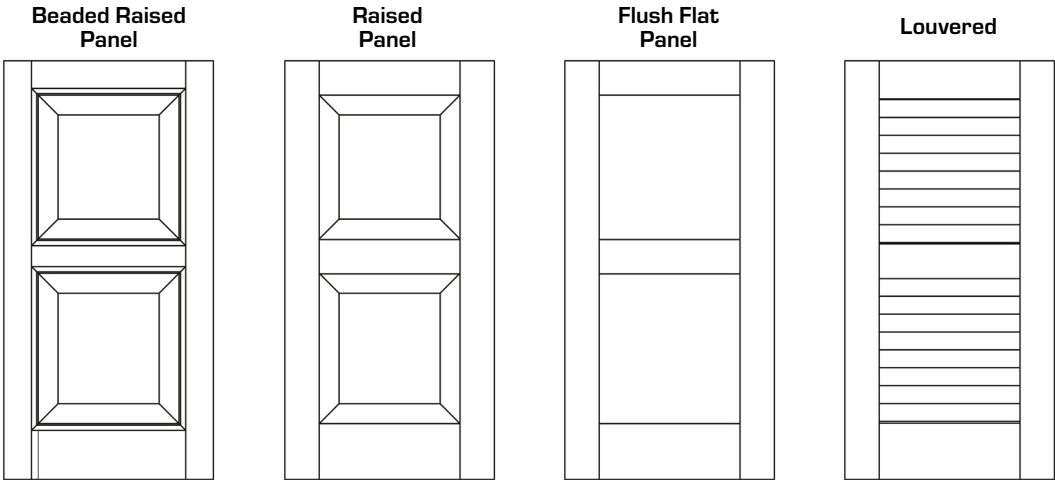

The rear detail of Beaded Raised Panel and Raised Panel is the same as the front of Flush Flat Panel.

Shutter Features

- Built To Custom Sizes
- Stainless Steel, Powder-Coated Hardware System Available
- Historically Accurate
- Approved For Historic Restoration
- Termite Proof; Will Not Rot Or Warp
- Available In 11 Pre-Finished Colors, Or Unfinished To Be Painted With A Premium Acrylic Coating (Including Dark Colors)
- Unfinished Shutters Will Need To Be Finished With A Solar Reflective Paint Before Installation
- Louvered Shutters Available With Or Without Horns



4 Shutter Styles



Optional Hardware



Paintable to Any Color



Easy Installation



GET AN INSTANT QUOTE!
www.intexmillwork.com

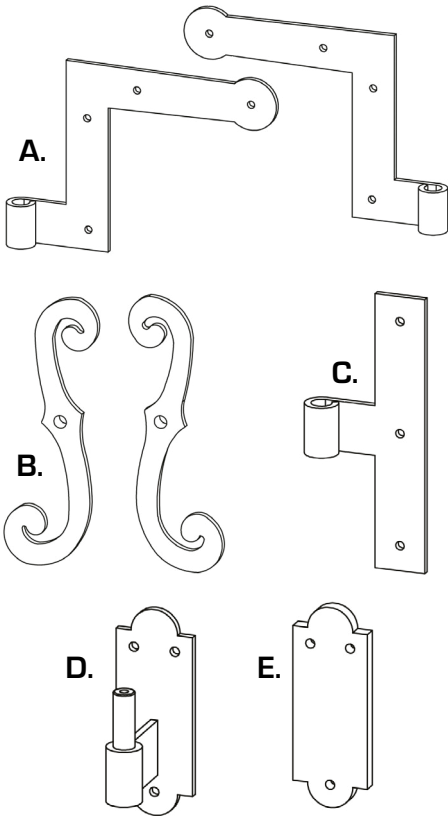

Optional Shutter Hardware

- A. 4 New York "L" Style Hinges, 2 Lefts, 2 Rights; Mounting Screws Included
- B. 2 Shutter Dogs with Mounting Brackets 1 Left, 1 Right; Mounting Screws Included
- C. 2 New York Style Mid Hinges; Mounting Screws Included
- D. 6 Pintels; Mounting Screws Included
- E. 6 Pintel Shims; Mounting Screws Included

Choose From 11 Pre-Finished Colors!



The above color swatches are digitally printed representations and may not be 100% accurate. Please request a paint swatch card from your INTEX Dealer! Shutters can be supplied unfinished to be painted with a Premium Acrylic Coating.

Millwork & More Hollow Rafter Tails

Hollow Rafter Tails



Hollow Rafter Tail Features

- Lightweight Tail Design
- Competitive Pricing
- Laminated End-Detail And A Pvc Skin On All Tail Faces Eliminates Exposed, Open Cells
- Available In 9 Standard Tail Patterns
- Hollow Design Allows For Easy Installation With Blocking Or Covering Existing Rafter Tails
- Beautiful, Sharp Lines
- Custom Rafter Tail Sizes And Patterns Are Available By Request
- Do Not Require Paint, But Can Be Painted With A Light Reflective Value (LRV) Of 55 Or Greater

Standard Tail Styles:

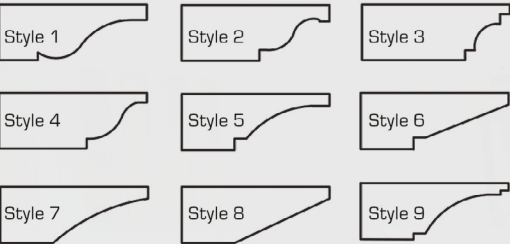

 **GET AN INSTANT QUOTE!**
www.intexmillwork.com

Millwork & More Hollow Brackets



HBKT-1

HBKT-2

HBKT-3

HBKT-4



 **GET AN INSTANT QUOTE!**
www.intexmillwork.com

Custom sizes for our standard Hollow Brackets and custom Hollow Bracket designs are available by request! Submit your designs to quotes@intexmillwork.com

Millwork & More

Window Surrounds, Entry Systems, Mouldings & Trim

Window Surrounds

A home isn't finished until it's dressed in a style all its own. Accentuate your home's existing architecture by using window surrounds. INTEX Window Surrounds can be manufactured to fit any shape or size window. With our large selection of frame, crown and sill options, INTEX surrounds save time and eliminate scrap connected with building surrounds on-site.



GET AN INSTANT QUOTE!
www.intexmillwork.com

Entry Systems

Transform a typical front door into a 'welcome home' statement. With choices of trim styles, headers and pediments, there are over 100 combinations - just right for any house style. Custom Entry Systems can be created for Historic Restoration, or for your unique style. Our trained staff will even assist on-site for complex door configurations!



GET AN INSTANT QUOTE!
www.intexmillwork.com

Mouldings & Trim

We fabricate mouldings from solid, cellular PVC boards using the same techniques as mills providing wood mouldings. Mouldings are milled to standard industry patterns, and sanded, primed and ready for installation. Custom milling is available to match existing profiles, or to satisfy any design specification required for your project!



GET AN INSTANT QUOTE!
www.intexmillwork.com



Millwork & More

Boston Gutter System



A Historically Accurate Gutter
That's More Durable Than Traditional Wood!



Boston Gutter Features

- Extruded Cellular PVC
- Full Aesthetic Appeal Of Wood
- Tested & Engineered by Independent Lab
- Available In 10 & 20 Foot Lengths
- Raidus Available In 18 Foot Lengths
- Bracket System To Hang & Float Gutter
- All Seams Utilize 3M VHB Seals
- Does Not Require Paint, But Can Be Painted with a Light Reflective Value (LRV) of 55 or Greater

Gutter Kits Available

- 90° Splice Kits for Inside & Outside Corners
- 180° Splice Kits
- End Cap Kits
- Downspout Outlet Kits

A Lifetime of Low Maintenance

Following our guidelines will ensure a successful gutter installation and a lifetime of low maintenance performance. As with any gutter system it's important to clean debris from the gutter periodically to ensure proper drainage.

Visit intexmillwork.com For Gutter Pricing!

Millwork & More

Additional Capabilities

Our Team Of Skilled Craftsmen Offer Limitless Custom Millwork Design Options!



From intricate details to innovative finishing touches, INTEX PVC custom millwork is created using advanced CAD design technologies, state-of-the-art fabrication equipment and hand-crafted techniques once reserved only for wood.

Craftsmanship That You Can Trust
Architects and builders rely on INTEX's strengths in both traditional workmanship and engineering technology to craft intricately detailed, high-quality millwork for distinctive homes and buildings.

- Some of Our Custom Millwork Capabilities:**
- Produced to precise design specifications, fabricated to order, packaged securely so that product arrives damage free – ready for installation.
 - Custom replication of brackets and other architectural details allow for a more accurate restoration.
 - Custom lattice and panels provide a stylish sense of security.
 - Custom railings and balusters per architect specs give a unique, elegant look.

Contact Us Today To Discuss How We Can Bring Your Custom Millwork Ideas Come To Life!



Commercial Applications

Our Engineered Products Meet International Building Code

You can count on the unsurpassed performance of INTEX's engineered systems. Innovative technology and fine craftsmen give INTEX the ability to meet any design specification. The easy to install INTEX "system" approach will also lower your construction labor costs.

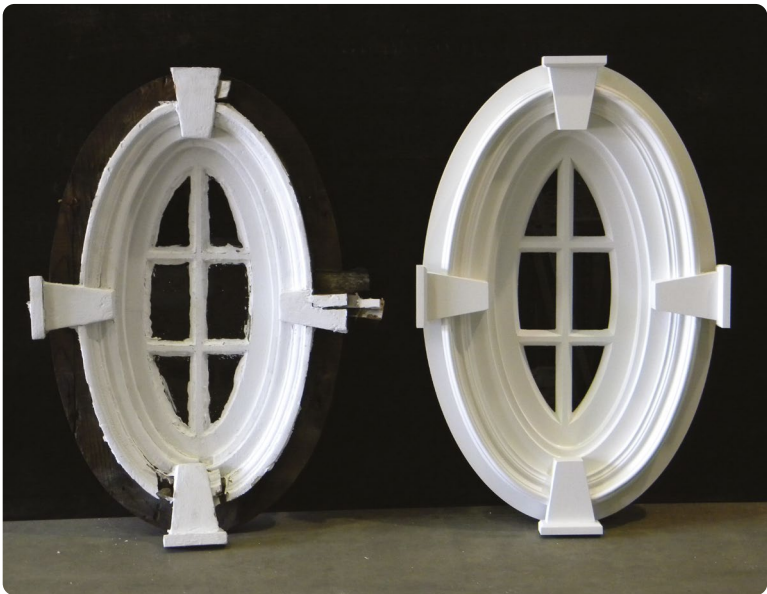

Historic Restorations

The Ability To Match Details & Craftsmanship Of The Original Millwork

The experienced skilled craftsmen at INTEX have the knowledge and creativity to protect and preserve your home's architectural heritage. By using INTEX's talent and innovative technology, intricate ornamental detailing and exquisite finishing touches can be readily created.

For the Architect Training & Education

Resources

We understand how important your reputation is — every structure you build needs to meet your clients’ standards, and with INTEX Millwork Solutions, you can rest assured that your projects will exceed expectations.

intexmillwork.com hosts important architectural resources, from DWG and PDF drawings, to Revit downloads, to our comprehensive installation instructions, and more. Every detail is considered to make your job easier!

AIA & LA CES Continuing Education

INTEX Millwork Solutions recognizes the importance of continuing education in architecture and is very proud to be a registered provider with AIA.org and ASLA.org (LA CES).

Our Sales Reps are happy to host a class at your office, at our facility in Mays Landing, NJ, or via video conferencing.

Classes (including our accredited Plant Tour) hosted at our facility will enjoy a tour of our new shop floor and a detailed overview of our brand new show room.



Thank You!

Many of the beautiful photographs throughout our catalog come from you! We’d like to thank the following customers and photographers for sharing images:

PHOTO CREDITS:

- | | | |
|----------------------------------|--------------------------------------|---------------------------------|
| • Anderson Campanella Architects | • Dever Architects | • Mid-Cape Home Centers |
| • Andy Slagel | • E.J. Jaxtimer Builder Inc. | • Nate Eldon Builders |
| • anncoen.com | • EJT Exteriors | • OSK Architects |
| • Aquatecture Associates | • Eldredge Lumber | • Period Architecture |
| • Architectural Elements | • Fenwick Architects | • Post To Post |
| • Architecture by Haryslak | • Goff Brothers Construction, Inc. | • QMA Architects |
| • Asher Slaunwhite Architects | • Halliday Architects | • Ryan Building Products |
| • Bellingham Fence | • Homeworks Construction | • Selectwood |
| • Bernardon Architects | • Hotel LBI | • TailorCraft Builders |
| • Blane Steinman Architects | • Interstate-Lakeland Lumber | • Universal Supply |
| • Botello Lumber | • Lorentz Architecture | • Whitla Brothers Builders Inc. |
| • Cape Cod Fence | • McLaughlin Construction Management | • Winslow Design, Inc. |
| • Christina Amey Architects | • Mercer Management & Development | |
| • David Bennett Architects | | |

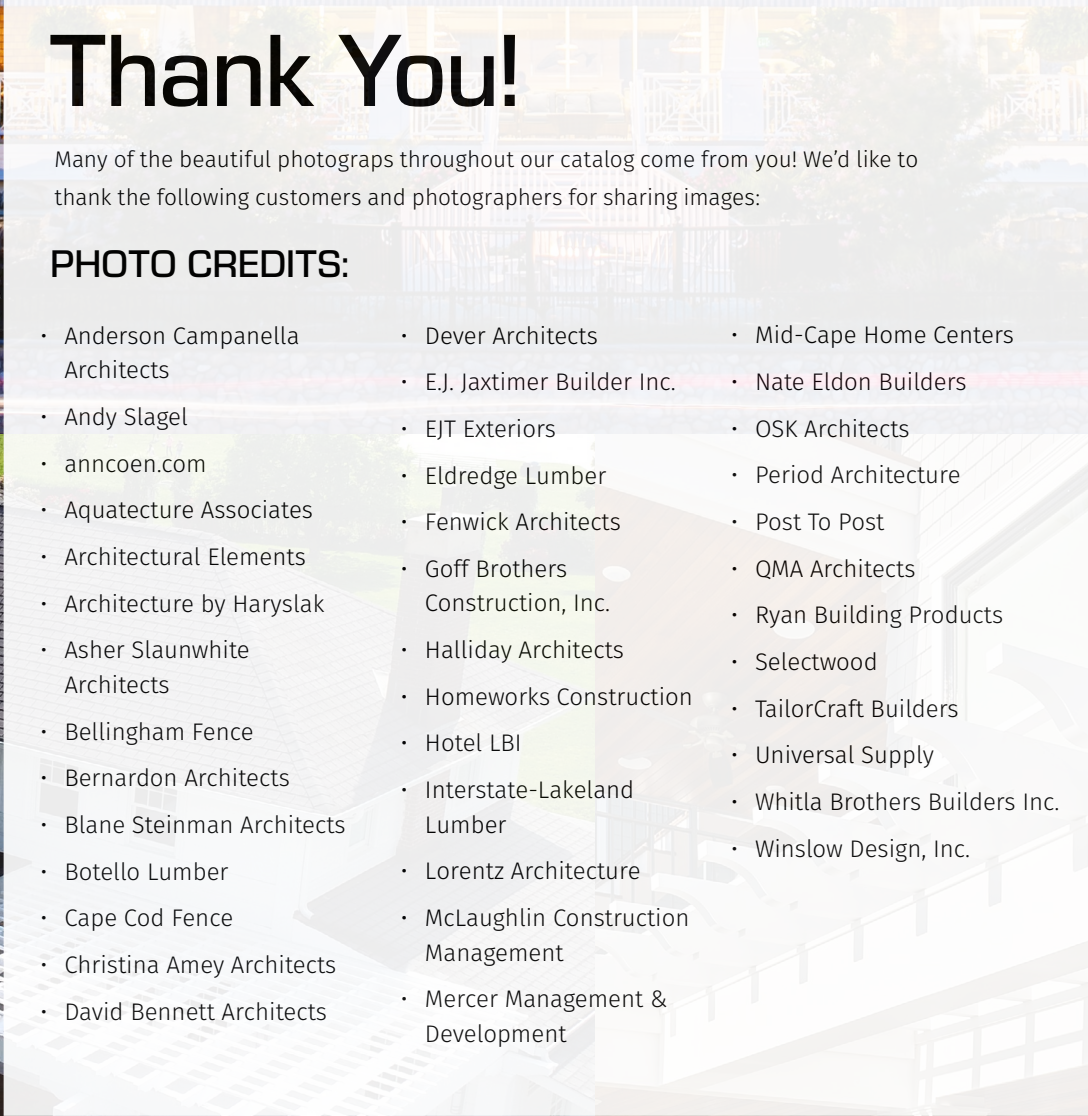

Available AIA and LA CES Courses

INTEXTOUR: INTEX Millwork Plant Tour | 2 AIA LU

Students will experience a detailed, inside look at the manufacturing process of INTEX Millwork Products. They will see first hand the entire production process, from raw materials to finishing, engineering, estimating, packaging and more.

INTEX20150126: Understanding the Benefits of Cellular PVC Rails and Pergolas | 1 AIA LU | 1 LA CES PDH

Students will gain a basic understanding of the benefits of specifying cellular PVC (Poly Vinyl Chloride) railing systems, pergolas and gutters for residential and commercial construction projects. Traditional materials like wood, vinyl, and composite materials have been the standard choices available for years, but these materials pose several challenges in aesthetics, durability, affordability, and limited design options.

INTEX-POOLCODE: Swimming Pool Enclosure Code Requirements Explained | 1 AIA LU, HSW | 1 LA CES PDH

Students will learn the details of swimming pool enclosure code requirements to ensure specific design and materials meet standard building code criteria for barrier and access requirements.

INTEX2020HSW: Hand Rail Code Requirements & Design Considerations | 1 AIA LU, HSW

Students will learn the details of railing systems code requirements and testing to ensure they meet IRC and IBC Building Codes. Integrating design elements based on materials and span limits into the structure architecture.

FREQUENTLY ASKED QUESTIONS

Can INTEX products be painted?

Yes, due to the inherent expansion and contraction characteristics of PVC, INTEX's PVC millwork products should only be painted colors with an LRV (light reflective value) greater than 55.

How do you clean Cellular PVC?

Cleaning all INTEX products are easy and fast with most major household cleaners. For specific recommendations and instructions, visit intexmillwork.com. Harsh cleaners with glycol ethers or ethanol type solvents and/or isopropyl alcohol are not recommended.

How long do INTEX products last?

INTEX products are designed to last in the harshest of environments. For this reason, all INTEX Millwork Solutions products carry a lifetime limited warranty.

Where can I purchase INTEX products?

Visit intexmillwork.com to find an authorized dealer near you.



INTEX[®]
MILLWORK SOLUTIONS

INTEX Millwork Solutions, LLC

45 Mill Street • Mays Landing, NJ 08330

(856) 293-4100

intexmillwork.com | [#intexmillwork](https://twitter.com/intexmillwork)

© 2020, INTEX Millwork Solutions, LLC

2021-1 Printing

Product Catalog

2021

intexmillwork.com